

Joie™

birth to 9kg/0-6 months

wish™

斜躺搖籃

## 使用說明書

組裝及使用本產品前  
請先閱讀說明書全文

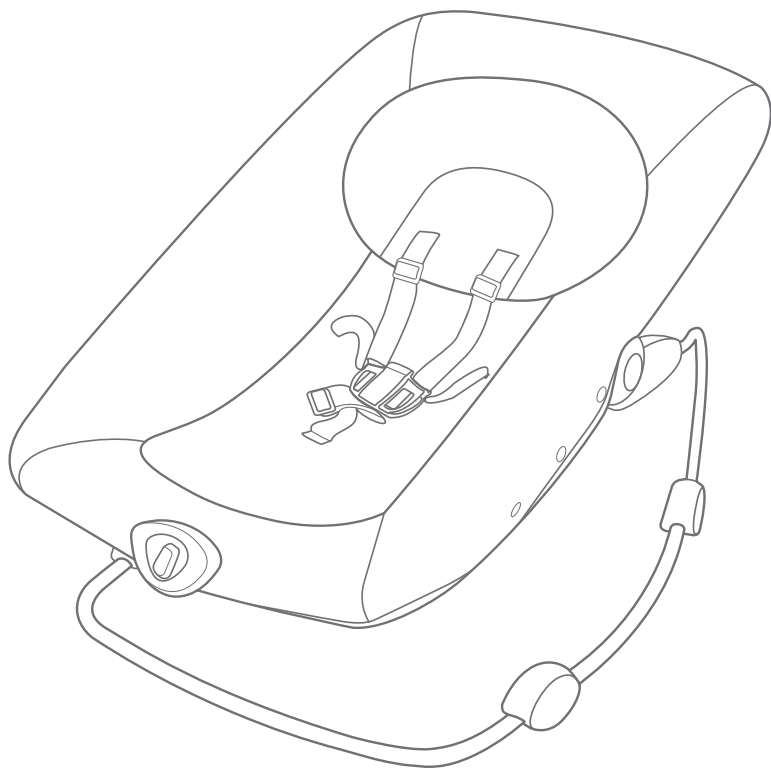

**重要！保留以備參照，請詳細閱讀。**

# 謝謝您使用本產品

您剛買了一台符合安全標準CNS 15982:2017 和歐洲安全標準EN 12790:2009 的高品質斜躺搖籃。這台搖椅適用於重量9公斤 (0-6個月) 以下的寶寶。

請仔細閱讀本說明書並依照指示操作，這樣才能保障並提供您的寶寶一個安全又舒適的使用環境。

本說明書中採用的插圖是為了說明產品的操作方法和產品結構，當插圖與實物存在差異時，請以實物為準。

## 功能介紹

背靠角度可調節  
座布透氣  
織帶超柔軟

！請保存好說明書，以便日后正確使用本產品。

## 目錄

|            |       |
|------------|-------|
| 參照圖示       | 3-6   |
| 中文         |       |
| 警告         | 7     |
| 緊急情況處理     | 9     |
| 產品資訊       | 9     |
| 產品組件及各部位名稱 | 10    |
| 保養維護與保固    | 10    |
| 產品組裝       | 11    |
| 組裝搖籃       | 11    |
| 產品操作       | 11    |
| 使用安全扣      | 11    |
| 調整背靠角度     | 11    |
| 使用玩具杆      | 11    |
| English    | 14-21 |

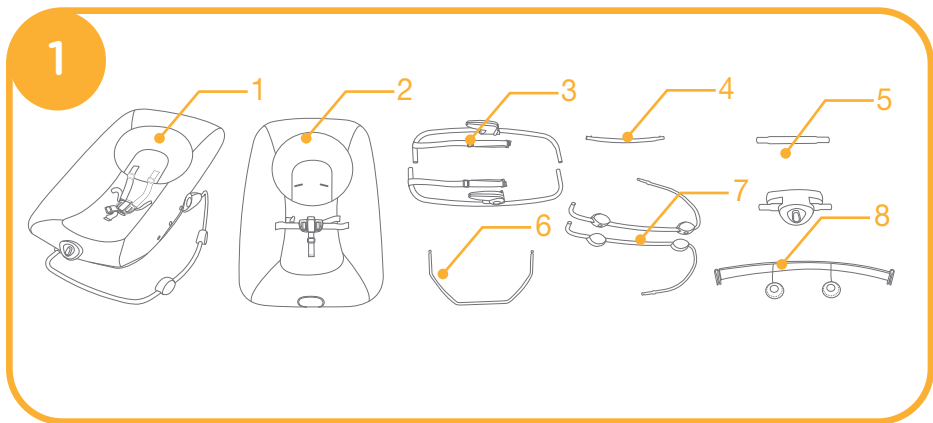

### 組裝搖籃

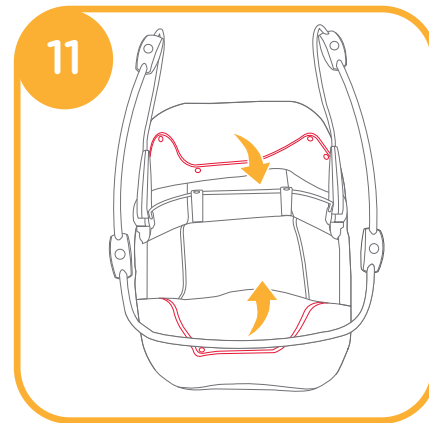
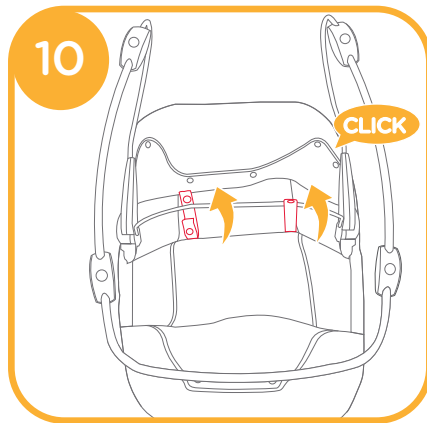
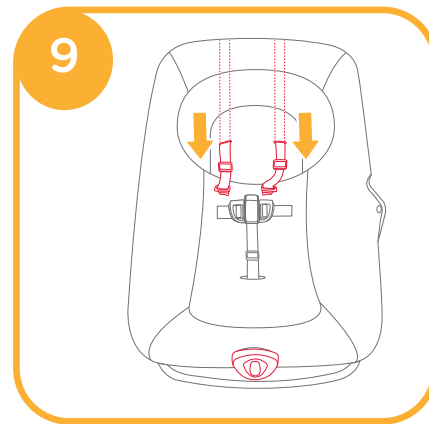
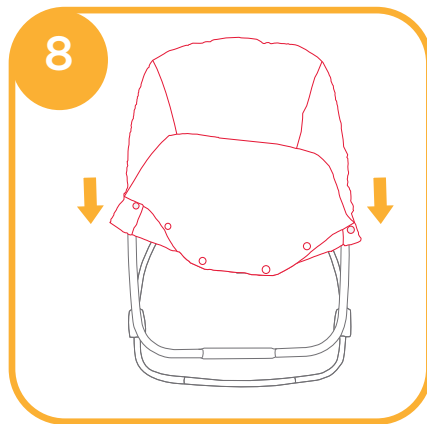
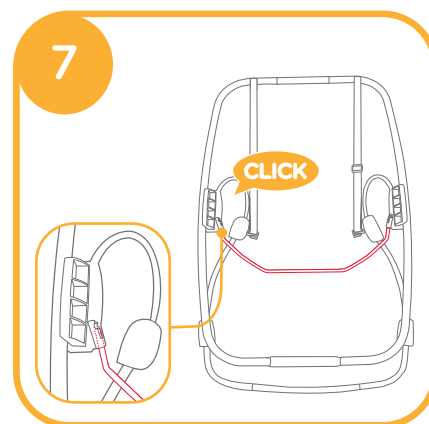
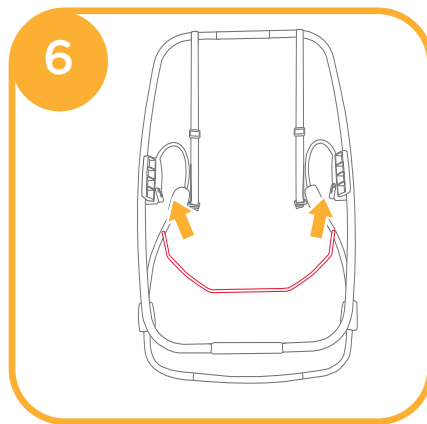
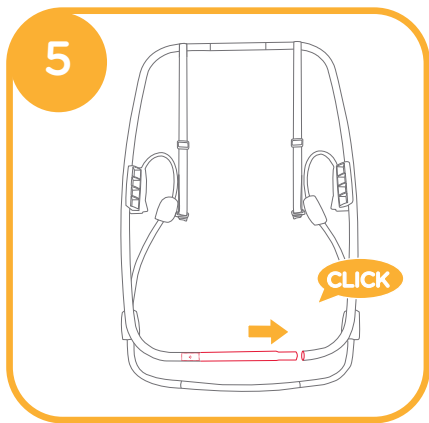
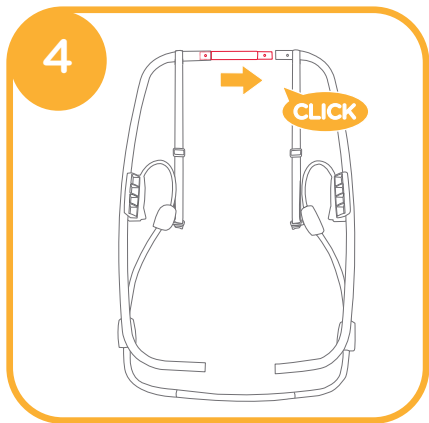
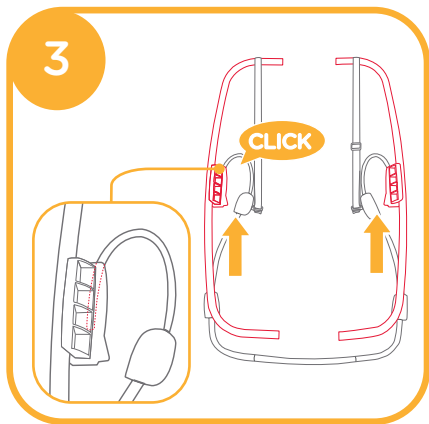
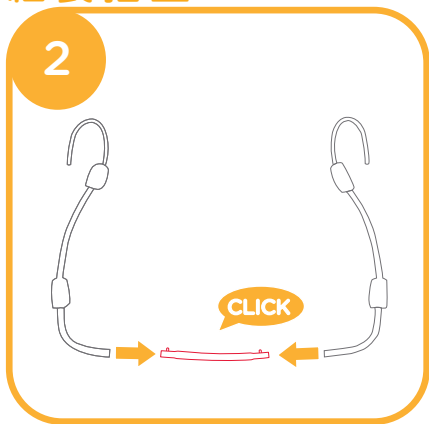

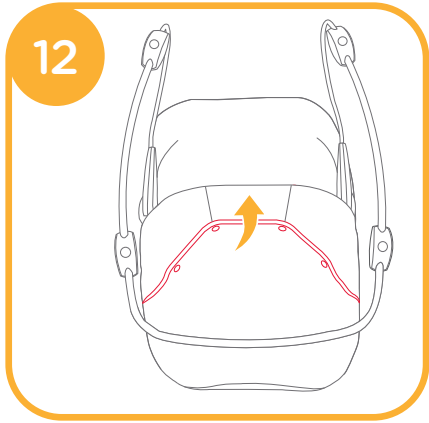

使用安全扣

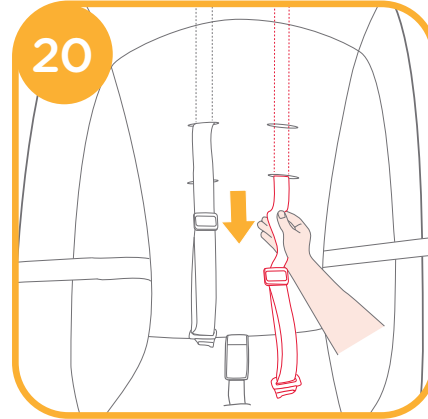
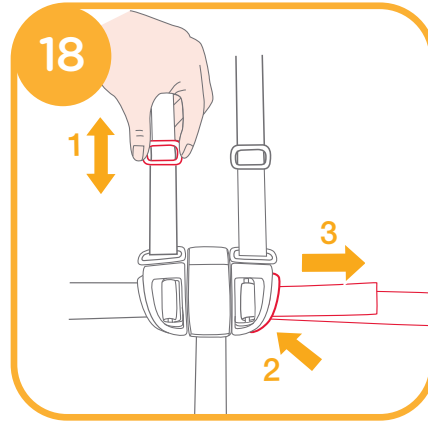
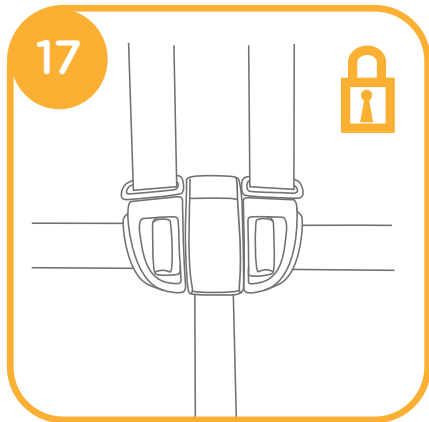
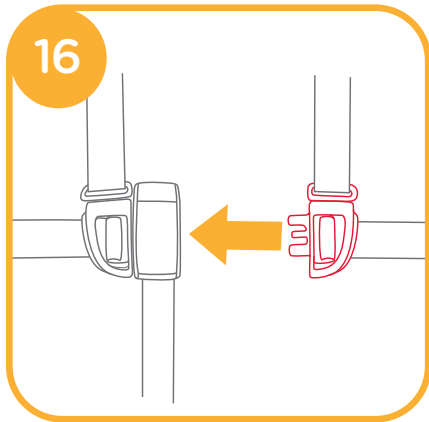
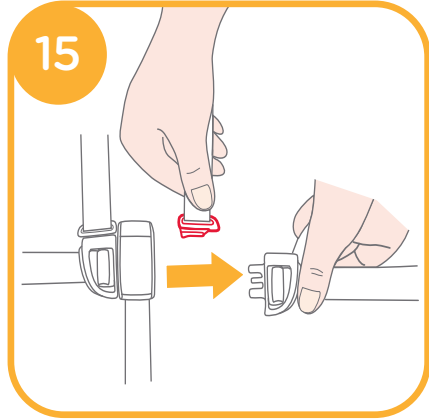
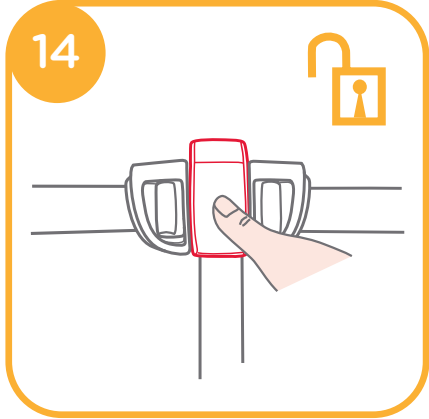
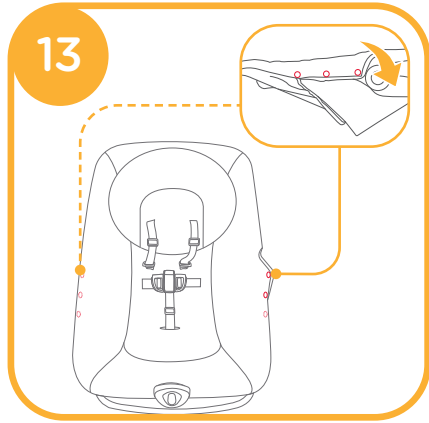

使用玩具杆

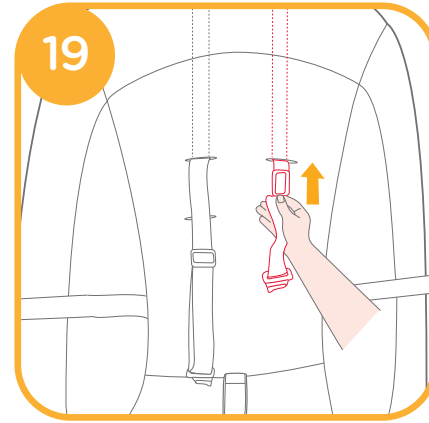
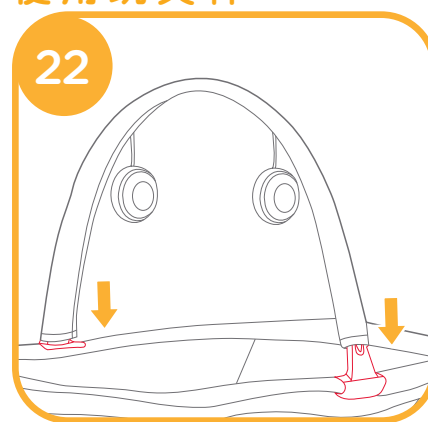

調整背靠角度

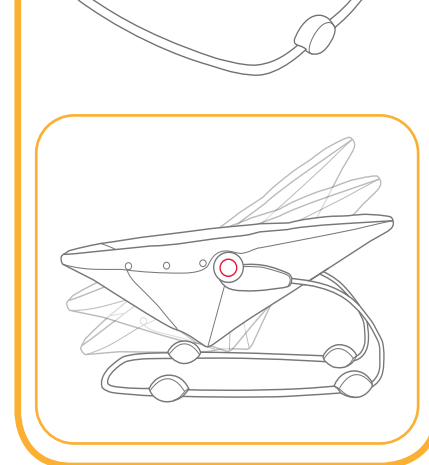
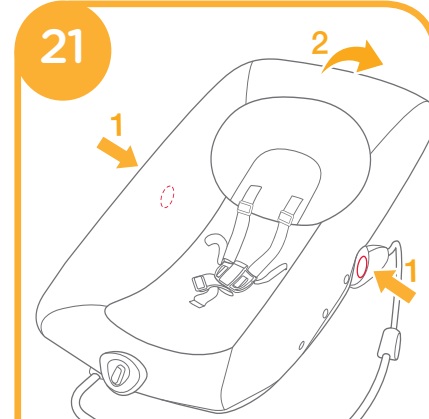

# 警告

- ! 本產品須由成人進行組裝。
- ! 嬰兒可自行坐立者，不得使用本嬰兒斜躺搖籃。
- ! 切勿在架高之表面(如桌子)上使用嬰兒斜躺搖籃。
- ! 確實使用束縛系統。
- ! 切勿使用玩具吊桿提攜嬰兒斜躺搖籃。
- ! 本嬰兒斜躺搖籃非供睡眠使用。
- ! 請勿允許您的寶寶將本產品當玩具玩耍。
- ! 寶寶乘坐在本產品內時，請不要搬運或舉起本產品。
- ! 為避免傷害，確保在收合打開該產品時兒童遠離產品。
- ! 嬰兒斜躺搖籃無法取代嬰兒床或小床，如嬰兒需要睡眠，則應將嬰兒放置在合適的嬰兒床或小床內。
- ! 使用時請遠離火源、高溫、水池或電源之附近範圍。
- ! 請勿將任何繩索或索帶類物件懸掛于寶寶頸部附近，或扣在產品及玩具上，以免導致寶寶意外窒息。
- ! 使用前請確定各部件安裝牢固以確保安全。
- ! 如任何組件破壞或遺失，切勿使用本嬰兒斜躺搖籃。
- ! 勿使用未經製造廠商認可的附屬配件或替換零件。
- ! 本產品適用寶寶之最大體重為9kg。
- ! 為避免發生纏結或勒死的傷害，當兒童開始用手或膝支撐站立時，請移除玩具。
- ! 為避免嬰兒或兒童窒息之危險，使用本產品前，請取掉PE袋和包裝材料並銷毀，並放到嬰兒和兒童觸摸不到的地方。

- ! 勿單獨留下嬰兒無人照顧。



# 緊急情況處理

遇緊急事故時，需將乘坐的寶寶移離現場。

## 產品資訊

### Allison Baby UK Ltd.

Venture Point, Towers Business Park,  
Rugeley, Staffordshire, WS15 1UZ  
www.joiebaby.com

**產品名稱** WISH斜躺搖籃  
**產品型號** B1707  
**適用範圍** 新生兒-9公斤(0-6個月)的寶寶  
**主要材質** 塑膠、五金、布  
**淨重** 3公斤  
**產品尺寸** 750mmx503mmx640mm  
**製造日期** 詳見產品上貼紙日期(年/月/日)  
**專利號碼** 專利申請中  
**原產地** 中國

**委製商** 巧兒宜國際股份有限公司  
**進口商** 巧兒宜國際股份有限公司  
**地址** 台北市內湖區瑞光路431號2樓  
**電話** 02-27973000  
**統一編號** 52603333

**代理商** 奇哥股份有限公司 Chickabiddy Co., Ltd  
**地址** 台北市南京東路四段186號5樓  
**服務專線** 0800-001-256 / 02-25781188  
**統一編號** 04222671  
**網址** www.chick.com.tw

使用本產品前請先閱讀說明書全文，如果您對於使用本產品還有任何疑問，請撥打服務熱線0800-001-256 / 02-25781188

## 產品組件 及各部位名稱

圖1.1 搖籃  
圖1.2 座布  
圖1.3 支撐架  
圖1.4 連接管A

圖1.5 連接管B  
圖1.6 支撐架連接管  
圖1.7 支撐腳  
圖1.8 玩具杆

因產品型號的不同，并非所有搖籃均附以上配件。組裝前請確認所有部件已經齊全，如有遺漏，請與銷售商聯繫。

## 保養維護與保固

- ! 本產品可用海綿和肥皂水擦洗。
- ! 請勿使用未經稀釋的中性清潔劑、汽油或其他有機溶劑清洗本產品，否則可能對產品造成損壞。
- ! 請勿使用漂白劑。
- ! 請定期檢查您的產品是否有破損的組件、撕裂的材料或車縫線，如有必要請隨時進行更換或修理。
- ! 當長時間不使用本產品時，請將產品存放於陰涼處及寶寶不易接觸的地方。



### 延長保固服務

請於購買起一個月內至奇哥官網進行登錄，登錄成功後即享有商品延長一年保固服務。

# 產品組裝

## 組裝搖籃

見圖2-圖13

# 產品操作

## 使用安全扣

見圖14-圖20

## 調整背靠角度

見圖21

## 使用玩具杆

見圖22

# Note

Joie™

birth to 9kg/0-6 months

## wish™ bouncer

**Instruction Manual**  
Please read all the instructions  
in this manual before installing  
and using the product.

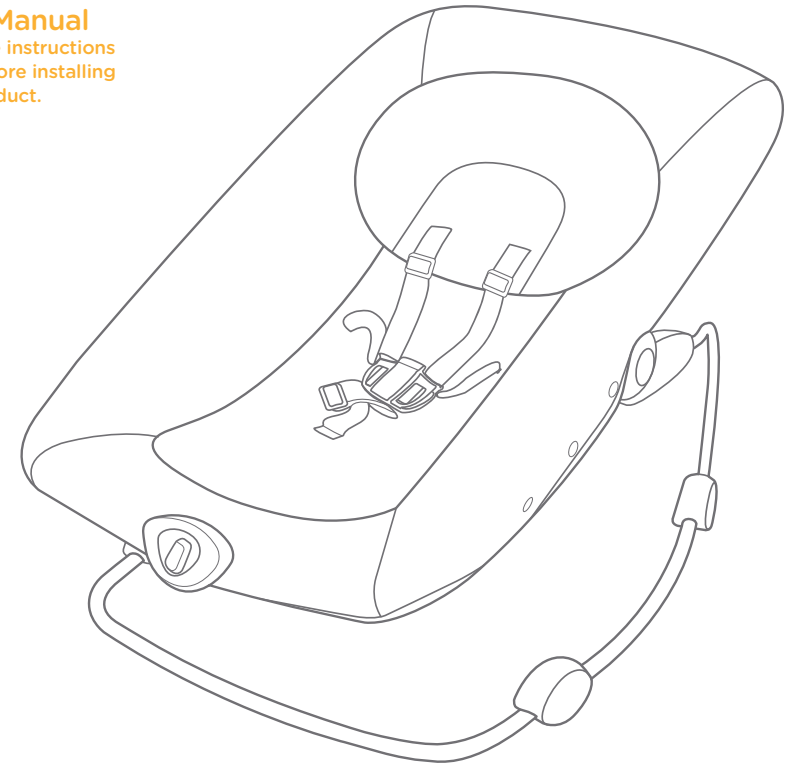

**IMPORTANT ! READ CAREFULLY AND KEEP  
FOR FUTURE REFERENCE**



# Thank you for purchasing Joie Bouncer

This product is a high-quality and fully functional bouncer, approved to Taiwan safety standards CNS 15982:2017 and European safety standards EN 12790:2009. It is suitable for a child weighing under 9kg (0-6 months).

Read these instructions carefully before use and keep them for future reference. Your child's safety may be affected if you do not follow these instructions.

The figures in this manual are to illustrate the operating methods and product main features. This model may have differences between features shown. The figures are just for reference.

## Bouncer Features

Adjustable Backrest  
Ventilative Seat Pad  
Extra Soft Harnesses

**IMPORTANT !  
KEEP FOR FUTURE REFERENCE**

# Contents

|                          |              |
|--------------------------|--------------|
| <b>Reference Figures</b> | <b>3 - 6</b> |
| <b>English</b>           |              |
| WARNINGS                 | 17           |
| Emergency                | 19           |
| Product Information      | 19           |
| Parts List               | 20           |
| Care and Maintenance     | 20           |
| <b>Product Assembly</b>  | <b>21</b>    |
| Bouncer Assembly         | 21           |
| <b>Product Operation</b> | <b>21</b>    |
| Use Buckle               | 21           |
| Adjust Recline Angle     | 21           |
| Use Toy Bar              | 21           |

# WARNINGS

- ! Adult assembly required.
- ! Discontinue using rocker when child reaches 9kg (approximately 0 - 6 months) or is able to climb out or is can sit unaided.
- ! It is dangerous to use this product on an elevated surface e.g. a table.
- ! Always use the restraint system.
- ! Never use the toy bar to carry the product.
- ! This product is not intended for prolonged periods of sleeping.
- ! Do Not let children play with this product.
- ! Do Not move or lift this product with the baby inside it.
- ! To avoid injury, ensure that children are kept away when unfolding and folding this product.
- ! This product does not replace a cot or a bed, Should your child need to sleep, then it should be placed In a suitable cot or bed.
- ! Be aware of the risk of open fire and other sources of strong heat such as electric bar fires, gas fires, etc in the vicinity of the product.
- ! To avoid strangulation, DO NOT place items with a string around your child's neck, suspend strings from this product, or attach strings to toys.
- ! All assembly fittings should be unfolded completely and tightened properly before using the product.
- ! Do Not use the product if any parts are broken, torn or missing.
- ! Do Not use accessories or replacement parts other than those approved by the manufacturer.
- ! To prevent possible injury by entanglement, remove this toy when the child starts trying to get up on its hands and knees in a crawling position.
- ! To avoid suffocation, remove plastic bag and packaging materials before using this product. The plastic bag and packaging materials should then be kept away from babies and children.

- ! Do Not use the reclined cradle once your child can sit unaided.
- ! NEVER leave the child unattended. Always keep your child in view.



# Emergency

In case of emergency or accidents, it is most important to have your child taken care of with first aid and medical treatment immediately.

# Product Information

## Allison Baby UK Ltd.

Venture Point, Towers Business Park,  
Rugeley, Staffordshire, WS15 1UZ  
www.joiebaby.com

|                     |  |
|---------------------|--|
| <b>Product</b>      | Bouncer  |
| <b>Model</b>        | B1707  |
| <b>Suitable for</b> | Child weighing under 9kg (birth - 6 months)              |
| <b>Materials</b>    | Plastics, metal, fabrics                                 |
| <b>Net Weight</b>   | 3kg  |
| <b>Product Size</b> | 750mmx503mmx640mm  |
| <b>Date</b>         | Please see detailed date on label (year / month / day)   |
| <b>Patent No.</b>   | Patents pending  |
| <b>Made in</b>      | China  |
| <b>Distributor</b>  | Chickabiddy Co., Ltd                                     |
| <b>Address</b>      | 5th FL, 186, Nanking E. Rd, Sec. 4, Taipei, Taiwan 10595 |
| <b>Tel.</b>         | 0800-001-256 / 02-25781188                               |
| <b>Website</b>      | www.chick.com.tw   |

Read all the instructions in this manual before using this product. If you have any further questions, please call 0800-001-256 / 02-25781188 directly.

# Parts List

**Fig. 1.1** Bouncer

**Fig. 1.2** Seat Pad

**Fig. 1.3** Support Frame

**Fig. 1.4** Link Tube A

**Fig. 1.5** Link Tube B

**Fig. 1.6** Link Tube For Support Frame

**Fig. 1.7** Support Leg

**Fig. 1.8** Toy Bar

Not all parts are included on some models. Make sure all parts are available before assembly. If any part is missing, please contact local distributor.

# Care and Maintenance

1. Your product can be spot cleaned with a sponge and soapy water.
2. Do not use undiluted neutral detergent, gasoline or other organic solvent to wash the product. It may cause damage to the product.
3. Do not use bleach.
4. From time to time, check your product for worn parts, torn material or stitching. Replace or repair the parts as needed.
5. If the product is not in use for a long period of time, please put it in the shade where your child cannot access it.

# Product Assembly

## Bouncer Assembly

see images Fig. 2 - Fig. 13

# Product Operation

## Use Buckle

see images Fig. 14 - Fig. 20

## Adjust Recline Angle

see images Fig. 21

## Use Toy Bar

see images Fig. 22



Allison Baby UK Ltd.  
Venture Point, Towers Business Park  
Rugeley, Staffordshire, WS15 1UZ

bring the kids™

Share the joy at [joiebaby.com](http://joiebaby.com)

IM-000352E