

# Joie™ signature

## i-Traver™ signature

### 使用說明書

本產品符合安全標準CNS 11497  
及歐盟標準ECE R129測試和認證  
組裝及使用本產品前  
請先閱讀說明書全文



ECE R129: i-Size

15 – 36kg (約3.5 – 12歲)的兒童

# 恭喜您

恭喜您成為 Joie 家族的一員！很高興能與您的寶寶共度行車旅程。乘坐本產品時，您的寶寶享受的是一台高品質和通過安全標準及歐盟安全標準檢測的 II / III 級車用兒童保護裝置。請仔細研讀並依照本說明書的指示操作，如此才能保障並提供您的寶寶一個安全又舒適的行車旅程。

本車用兒童保護裝置適用於有 ISOFIX 固定裝置的汽車，因本車用兒童保護裝置是依安全標準 CNS 11497 和歐盟安全標準 ECE R129 去做測試和認證的。台灣區域使用請依照 CNS 標準規範。

這台車用兒童保護裝置適用於體重 15–36kg (約 3.5–12 歲) 的兒童。

## 車用兒童保護裝置

！重要：請仔細閱讀並妥善保存本說明書，以便日後參考。

本說明書不使用時，請存放在底座下方的存儲空間內(如下圖)。安裝和使用本產品前，請先閱讀說明書全文。

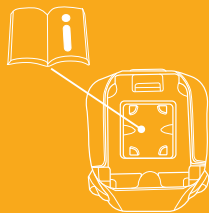

## 產品組件及各部位名稱

請確認產品組件是否有遺漏，如有遺漏，請聯繫代理商。本產品無需工具進行組裝。

- |            |               |
|------------|---------------|
| 1 頭靠       | 6 頭靠調整拉桿      |
| 2 背靠       | 7 肩帶導向器       |
| 3 扶手       | 8 Isosafe 連接器 |
| 4 座椅深度調整按鈕 | 9 ISOFIX 導向器  |
| 5 底座       |               |

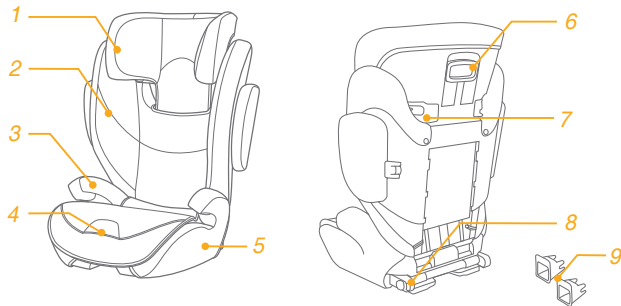

# 警告

- ! 必須小心定位和安裝兒童保護裝置，以免被活動式座椅或車門卡住。
- ! 兒童保護裝置適用於體重15–36kg（大約3.5–12歲的兒童）。
- ! 勿提供2歲以下兒童乘坐。
- ! 任何束縛兒童保護裝置至車輛之織帶應束緊，任何束縛兒童之織帶應根據兒童身體進行調節，且此織帶不應扭曲。
- ! 將寶寶放在本兒童保護裝置後，必須正確的扣合及使用安全帶，並確保腰部織帶能有效束縛骨盆部位。
- ! 不正確使用或安裝本兒童保護裝置，當緊急剎車和急轉彎時，可能會導致嚴重受傷或死亡的危險。
- ! 請勿使用其它廠商生產的兒童保護裝置座墊。請與代理商聯繫只可使用Joie配件更換零件。
- ! 請勿使用說明中未有顯示的任何配件。
- ! 請勿將此產品安裝在前座上，防止意外發生時造成乘坐的兒童傷亡。
- ! 在無人照料下，不得讓兒童留在兒童保護裝置內。
- ! 請勿將未使用汽車安全帶固定住的兒童座椅留在車內，以免緊急剎車時，傷害到其他乘客。若不經常使用兒童保護裝置時，請將其搬離汽車座椅。
- ! 任何行李或其他可能在碰撞中造成傷害之物品應適當牢固。
- ! 本兒童保護裝置若於意外中遭受劇烈撞擊後，不可繼續使用，應立即更換兒童保護裝置。意外可能導致兒童保護裝置產生潛在危險。
- ! 請勿在兒童保護裝置上進行未經驗證許可之改裝或增加其他裝置以及未依兒童保護裝置製造商提供之安裝說明使用，以免造成受傷或死亡。
- ! 請勿使用已經損壞或缺失零件的兒童保護裝置。請勿使用切割過的、磨損的或損壞的車輛安全座椅。
- ! 請讓座椅遠離日光，以免產品溫度過高對兒童的皮膚造成傷害。

- ! 請勿在未閱讀或了解本兒童保護裝置說明書及汽車說明書之前，使用或安裝本兒童保護裝置。因為可能會導致嚴重受傷或死亡的危險。
- ! 請勿使用二手兒童保護裝置或來歷不明的兒童保護裝置，因為它們可能存在危害乘坐兒童安全的潛在危險。
- ! 當本兒童保護裝置沒有座布時，請勿使用，因座布為兒童保護裝置束縛性能之整體構成要件。
- ! 請勿使用非本製造商推薦的座布，否則會影響兒童保護裝置的總體性能。
- ! 有關零件更換或維修問題，請向代理商諮詢。
- ! 請勿把本兒童保護裝置當作平常的椅子使用，會容易翻倒造成傷害。
- ! 不可使用繩子等其他物件代替汽車安全帶，以免兒童被意外勒住。
- ! 請勿讓您的寶寶穿著過大的衣物，所穿的衣物必須能讓兒童保護裝置的安全帶適當而安全地扣在寶寶兩腿之間。
- ! 使用本產品前，請取掉PE袋和包裝材料，並放到嬰兒和兒童觸摸不到的地方。
- ! 請勿搬運乘坐有兒童的兒童保護裝置。
- ! 不要使用非說明書中所述以及兒童保護裝置中所標示的其他受力點。
- ! 請勿後向使用兒童保護裝置。

# 緊急情況處理

遇緊急事件或事故時，需迅速急救或送醫治療照顧您的寶實是非常重要的。

## 產品資訊

使用產品之前請閱讀說明書中的所有說明。

此兒童保護裝置僅適用符合CNS 3972或其他等效標準之三點式安全帶之車輛座椅使用。不適用於裝有二點式安全帶的汽車座椅上。

三點式安全帶安裝兒童保護裝置，這是“通用型”兒童保護裝置。

Isosafe連接裝置和三點式安全帶安裝兒童保護裝置，這是“半通用型”兒童保護裝置。

若有疑問，請洽兒童保護裝置製造商或代理商。

### 三點式安全帶安裝兒童保護裝置

1. 此為“通用型”兒童保護裝置，符合安全標準CNS 11497及歐盟標準ECE R129。其適用大部分（並非全部）之車輛座椅。
2. 若車輛製造商在車主使用手冊中述明其可適用此質量等級之“通用型”兒童保護裝置，則本裝置可安裝於該車輛上。
3. 此兒童保護裝置歸類為“通用型”，比其他無標示此注意事項之兒童保護裝置可適用於較多車輛。
4. 若有疑問，請洽兒童保護裝置製造商或代理商。

### Isosafe連接裝置和三點式安全帶安裝兒童保護裝置

1. 此兒童保護裝置被歸類為“半通用型”，符合安全標準CNS 11497。用於裝有ISOFIX固定器系統之車輛座椅上。
2. 其他車輛型式亦有可能適用此兒童保護裝置。若有疑問，請洽兒童保護裝置製造商或代理商。

Allison Baby UK Ltd.

Venture Point, Towers Business Park,  
Rugeley, Staffordshire, WS15 1UZ

[www.joiebaby.com](http://www.joiebaby.com)

產品名稱	汽車用兒童保護裝置
產品型號	C1903
適用範圍	15-36kg(約3.5-12歲)的兒童
主要材質	塑膠、五金、布
質量等級	II/III
淨重	5.6kg
產品尺寸	630mmx560mmx400mm
製造日期	詳見產品上貼紙日期(年/月/日)
專利號碼	專利申請中
原產地	中國

委製商	巧兒宜國際股份有限公司
進口商	巧兒宜國際股份有限公司
地址	台北市內湖區瑞光路431號2樓
電話	02-27973000
統一編號	52603333

代理商	奇哥股份有限公司 Chickabiddy Co., Ltd
地址	台北市南京東路四段186號5樓
服務專線	0800-001-256/02-25781188
統一編號	04222671
網址	<a href="http://www.chick.com.tw">www.chick.com.tw</a>

# 產品組裝

見圖 1 - 5

1. 按壓頭靠調整拉桿，並對齊背靠垂直插入。頭靠座布需要在背靠座布下方 ①  
! 請嘗試拉動，以便檢查兩部份是否已正確卡合。
2. 當背靠安裝到底座上時先用力把背靠下壓，背靠上的U型鉤與底座上橫桿會相互卡合 ②
3. 向上旋轉背靠 ③

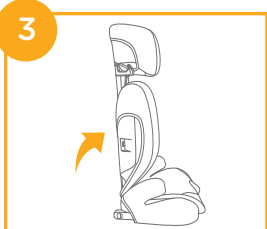
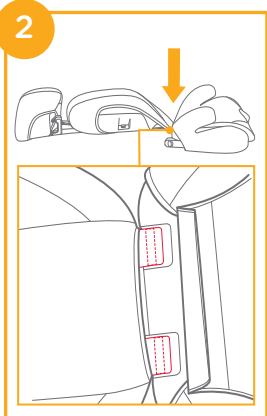
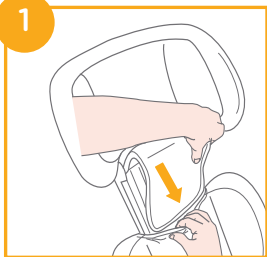

4. 使側向保護塑膠凸台和背靠上的凹槽對齊插入 ④ ⑤

! 請根據汽車的尺寸來選擇是否安裝側撞保護塊。

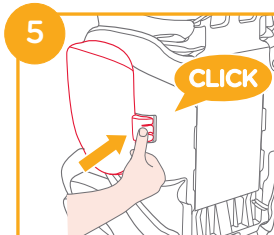
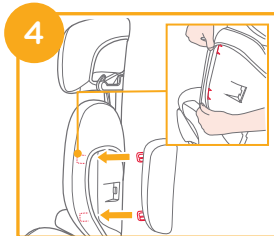

# 座椅調整

見圖 6

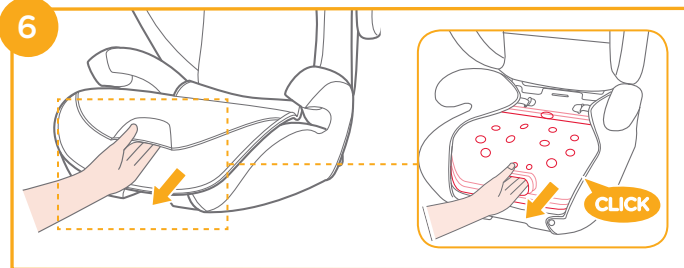

## 頭靠高度調整

見圖 7

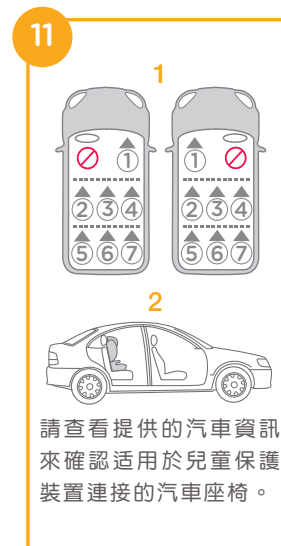
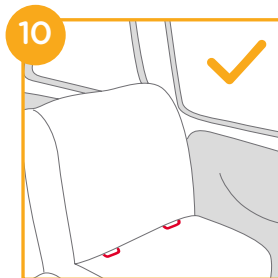
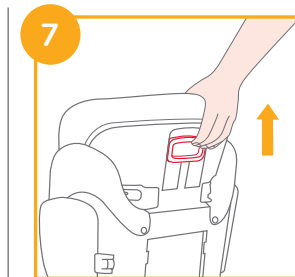

請查看提供的汽車資訊來確認適用於兒童保護裝置連接的汽車座椅。

## 安裝注意事項

見圖 8 - 11

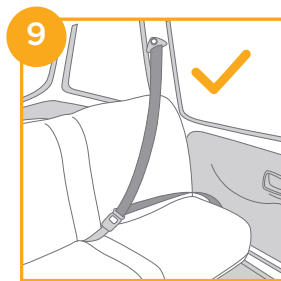
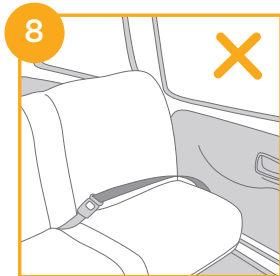

## Isosafe 連接裝置和三點式安全帶安裝或僅用三點式安全帶安裝兒童保護裝置

(前向模式 / 15-36kg / 3.5-12 歲)

見圖 12 - 24

如果在座椅背靠下方有鐵環，可以使用連接器去連接。對它的位置和使用要求可以參考汽車使用說明。

1. 將ISOFIX導向器固定到ISOFIX固定點上，ISOFIX導向器既可防止汽車座椅表面被刮破，又可為Isosafe連接器導向 12
2. 按壓底座的Isosafe調整按鈕，拉出Isosafe連接器 13
3. 將Isosafe連接器旋轉180度直到它們指向ISOFIX導向器的方向 14

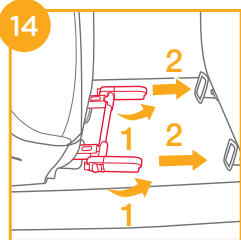
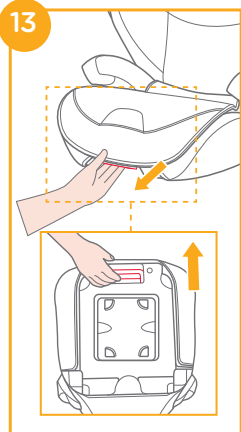
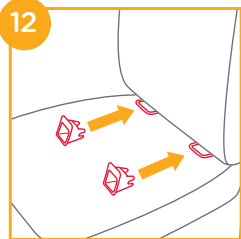

4. 將Isosafe連接器與ISOFIX固定點對齊，然後將兩個Isosafe連接器與ISOFIX固定點卡合連接 15

! 請確定左右兩邊的Isosafe連接器都已固定到ISOFIX固定點上且兩個Isosafe連接器上的指示器應顯示綠色 15 -1

! 同時往外拉兩邊的Isosafe連接器，以確保Isosafe連接器已固定。

5. 移除兒童保護裝置:

- a. 移除Isosafe連接器時，按壓連接器上的第二道安全鎖 16 -1與釋鎖按鈕 16 -2，然後將Isosafe連接器往外拉即可。

- b. 將Isosafe連接器旋轉180度，然後按壓Isosafe收合按鈕來收合Isosafe連接器 17

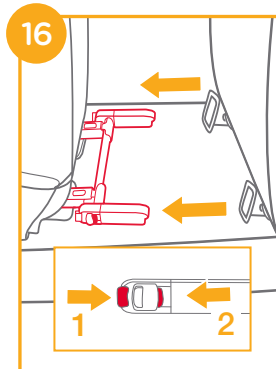
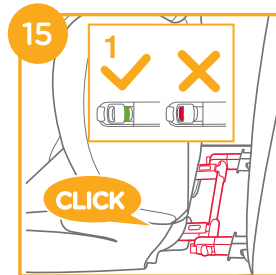

17

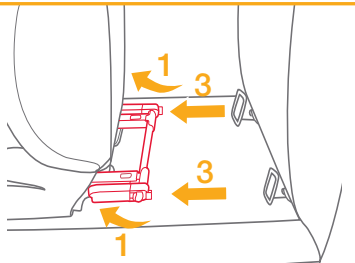
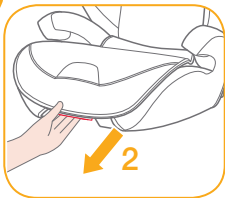

18

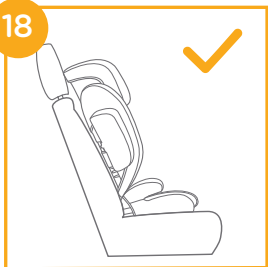

19

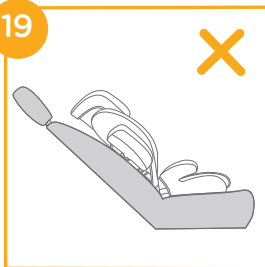

! 將汽車安全帶穿過兒童保護裝置路徑如 20 所示。並扣合安全帶夾器 20 -3

20

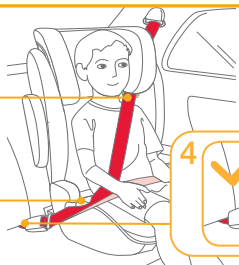

! 也可以僅通過3點式安全帶連接  
(見圖 20 - 24)

! 肩帶必須要穿過肩帶導向器 20 -1

! 安全帶必須通過扶手下方 20 -2

! 汽車安全帶母扣段若太長，汽車安全帶無法綁緊不能使用 20 -4

! 兒童被放置在兒童保護裝置裏後，必須正確使用安全帶，確保腰帶固定在靠下方位置，這樣使骨盆牢固固定 20

! 如 21 所示，為保證正確的頭靠高度，頭靠的底部必須與兒童肩膀的最高點水平且肩帶必須穿過綠色區域橫跨兒童肩膀 22

! 請將兒童安全座椅牢固地與配置有腰帶/肩帶的前向汽車座椅的背靠抵接。

21



22





! 確保安全帶的肩帶部分直接穿過肩帶導向件如圖 23

! 通過拉松馳的肩帶來拉緊汽車安全帶。

! 如果安全帶橫跨了兒童的脖子、頭部或面孔，須重新調整頭靠高度。

! 所有將兒童保護裝置保持在汽車上的安全帶應該都是緊的，請確保汽車安全帶沒有鬆弛或扭曲。



依相反步驟即可重新組裝座布。

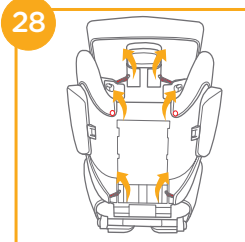
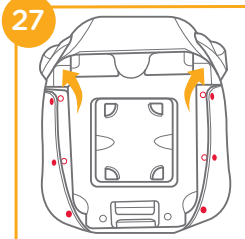

## 拆卸座布

見圖 25 - 28

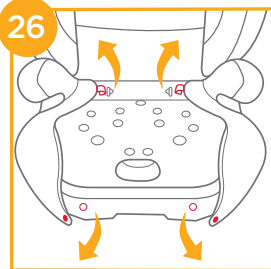
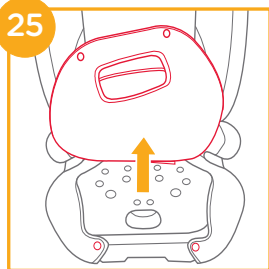

## 保養維護與保固

- ! 請以30度以下水溫清洗。
- ! 請勿使用熨斗熨燙。
- ! 請勿使用漂白劑及乾洗。
- ! 請勿使用未經稀釋的中性清潔劑、汽油或其他有機溶劑清洗本兒童安全座椅，否則可能對車用兒童保護裝置造成損壞。
- ! 請勿大力扭乾，過分大力扭乾可能留下皺褶。
- ! 請於陰涼處鋪平晾乾。
- ! 當長時間不使用本車用兒童保護裝置時，請將車用兒童保護裝置從汽車座椅上拆除，並存放於陰涼處及兒童不易接觸的地方。



### 延長保固服務

請於購買起一個月內至奇哥官網進行登錄，登錄成功後即享有商品延長一年保固服務。



## 汽車安裝資訊



1. 其他車輛型式亦有可能適用此兒童保護裝置。以下車型主要為歐洲銷售車款安裝適配性資料。若有疑問，請洽兒童保護裝置製造商或代理商。
2. 兒童保護裝置不能安裝於前座之位置。
3. ● 表示汽車座椅可安裝本兒童保護裝置。
4. ✕ 表示汽車座椅不可安裝本兒童保護裝置。
5. ⚡ 表示用電或其它混合驅動的車輛。
6.  表示符合i-size的車輛。
7. **SB!** 表示汽車地板下有儲存盒。
8. 將此座椅安裝在地板下有儲物盒的汽車上時，請參考汽車使用說明書或聯繫代理商。  
! 表示汽車地板下儲物盒的位置。
9. 如果您的汽車品牌未被列入本說明書或未用“●”或“✕”進行標示，請查閱您的汽車手冊或聯絡兒童約束系統製造商，以進一步了解相關資訊。

# Joie™ signature

---

## i-Traver™ signature

### Instruction Manual

This child restraint is approved to CNS 11497 and UN ECE R129 series of amendments.

Please read all the instructions in this manual before installing and using the product.



ECE R129: i-Size

Child height 100cm-150cm

# GB Welcome to Joie™

Congratulations on becoming part of the Joie family! We are so excited to be part of your journey with your little one. While traveling with the i-Traver™ series high back booster you are using a high quality, fully certified safety enhanced child restraint. Please carefully read this manual and follow each step to ensure a comfortable ride and best protection for your child.

To use this Joie booster with the ISOFIX connections according to the CNS 11497 and ECE R129/03, your child must meet the following requirements.

Child height 100cm-150cm (Reference age 3.5-12 years).

## Booster

Please read all the instructions in this manual before installing and using the product.

**! IMPORTANT: KEEP FOR FUTURE REFERENCE.  
PLEASE READ CAREFULLY.**

Please keep the instruction manual in the storage compartment at the bottom of the booster as right figure.

For warranty information, please visit our website at [joiebaby.com](http://joiebaby.com)

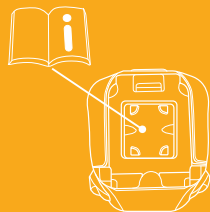

## Parts List

Make sure all parts are available before assembly. If any part is missing, please contact local retailer. No tools are required for assembly.

- |   |                              |   |                               |
|---|------------------------------|---|-------------------------------|
| 1 | Head Support                 | 6 | Head Support Adjustment Lever |
| 2 | Lower Back Support           | 7 | Shoulder Belt Guide           |
| 3 | Armrest                      | 8 | ISOFIX Connector              |
| 4 | Seat Depth Adjustment button | 9 | ISOFIX Guides                 |
| 5 | Base                         |   |                               |

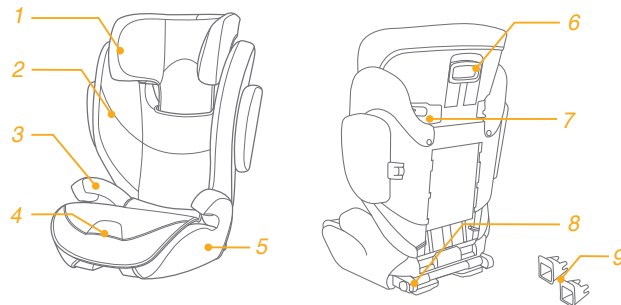

## WARNING

- ! NO booster can guarantee full protection from injury in an accident. However, proper use of this booster will reduce the risk of serious injury or death to your child.
- ! Always take care to follow the installation instructions correctly, this will ensure the booster performs at an optimum safety level.
- ! Do take care so that the rigid items and plastic parts of an booster shall be so located and installed that they are not liable to become trapped by a moveable seat or in a door of the vehicle.
- ! To use this booster seat according to the ECE R129/03, your child must meet the following requirements.  
Child height 100cm-150cm (reference age: 3.5-12 years). Forward facing only (in vehicle travel direction)
- ! The booster may not fit to all vehicles for the usage from 135cm-150cm.
- ! Any straps holding the booster to the vehicle should be tight and the straps should not be twisted.
- ! The booster seat should be replaced if it has been subjected to heavy loads in the event of an accident or if it has been dropped.
- ! This booster seat is only intended to be used in the car.

## WARNING

- ! Do not make any alterations or additions to the booster seat without approval from the type approval authority. DO NOT remove any of the white EPP/EPS foams. Failure to do so may result in serious safety issues.
- ! DO NOT use the seat if the surfaces are too hot from sunlight.
- ! Never leave the child unattended in the booster seat or vehicle, not even for a few minutes.
- ! Any luggage or other objects liable to cause injuries in the event of a collision shall be properly secured.
- ! The booster shall not be used without the soft goods.
- ! The booster soft goods should not be replaced with any other than the one recommended by the manufacturer, because the soft goods constitutes an integral part of the restraint performance.
- ! Always secure child in booster, even on short trips, as this is when most accidents occur.
- ! DO NOT leave this booster, or other items unbelted or unsecured in your vehicle. Remove the booster seat from the car if not regular used and store in a dry, sun-protected surrounding.

## WARNING

- ! It's recommended not to use a second-hand booster seat whose history is not known. It may have invisible structural damages or defects due to incorrect usage/storage.
- ! DO NOT use any load bearing contact points other than those described in the instructions and marked on the booster.
- ! DO NOT install this booster under the following conditions:
  1. Vehicle seats facing sideways or rearward with respect to the vehicle's direction of travel.
  2. Vehicle seats movable during installation.
- ! Consult the retailer for issues concerning maintenance, repair and part replacement.

## Emergency

In case of emergency or accidents, it is most important to have your child taken care of with first aid and medical treatment immediately.

## Product Information

1. This is an Enhanced Child Restraint System, intended to use as a Non-integral Universal Enhanced Child Restraint System (i-Size booster seat) from 100-150cm.
2. It is approved to the latest UN R129/03.

<b>Product</b>	Booster seat
<b>Materials</b>	Plastics, Metal, Fabrics
<b>Patent No.</b>	Patents pending
<b>Suitable for</b>	Child height 100cm-150cm (Reference age 3.5-12 years).
<b>Installation</b>	Forward facing (in vehicle travel direction)

# Booster Assembly

see images 1 - 5

1. Squeeze the head support adjustment lever first and then slide in lower back support under the fabric cover to connect them together. 1
- ! CHECK to make sure two pieces are securely snapped together by pulling on them.
2. To attach the lower back support to the base, hook the lower back support over the seat bar hinge on the base. 2
3. Rotate the lower back support up while holding the booster seat until it clicks into an upright position. 3

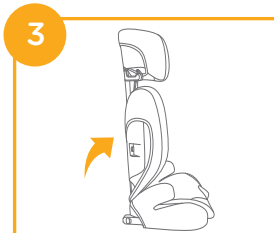
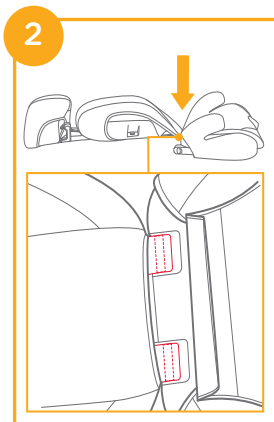
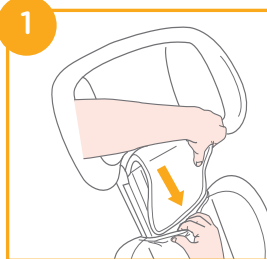

4. Align the side impact shield with the slot of lower back support plastics mounts, and then insert to lock. 4 5

! Please choose whether to install the side impact shield according to the size of the car.

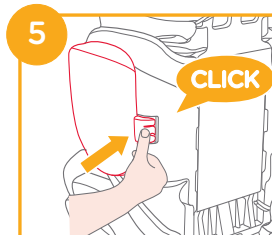
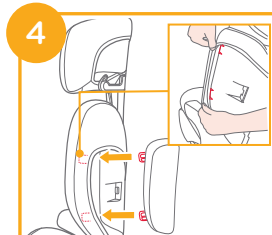

## Adjust the seat

see image 6

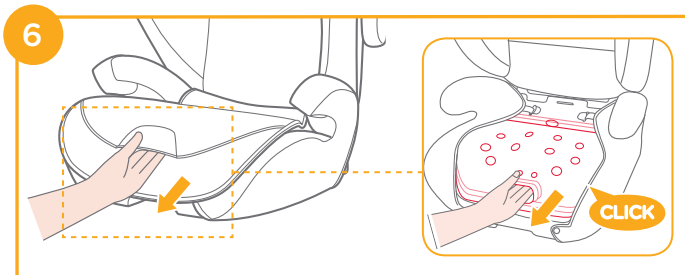

## Height Adjustment - for Head Support

see image 7

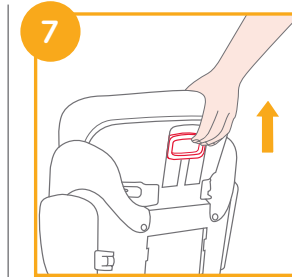

## Concerns on Installation

see images 8 - 11

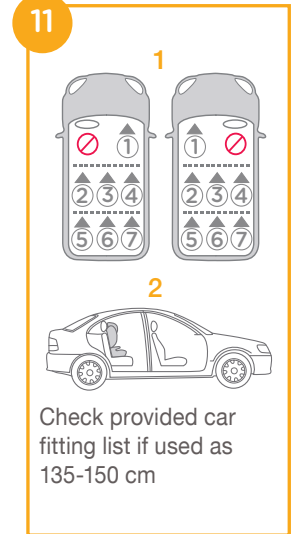
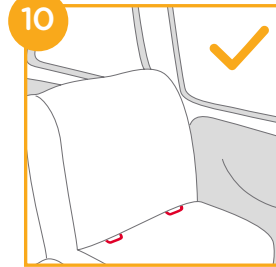
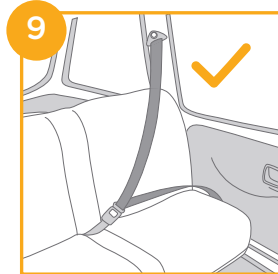
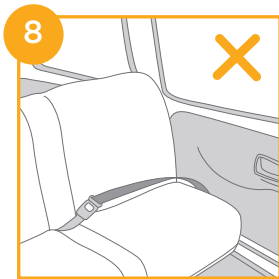

## Installation using ISOFIX System and 3-point belt or using 3-point belt only

(Forward Facing Mode/ for Child between 100cm-150cm / 3.5-12 years old)

see images 12 - 24

If vehicle is equipped with ISOFIX, the vehicle lower anchor points may be visible at the vehicle seat crease. See your vehicle owner's manual for exact locations, anchor identification, and requirements for use.



1. Fit the ISOFIX guides with the ISOFIX anchor points. **12** The ISOFIX guides can protect the surface of the vehicle seat from being torn. They can also guide the ISOFIX connectors.

2. Press the ISOFIX adjusting button to pull out the ISOFIX connectors. **13**

3. Rotate the ISOFIX connectors 180 degrees until they are pointing in the direction of the ISOFIX guides. **14**

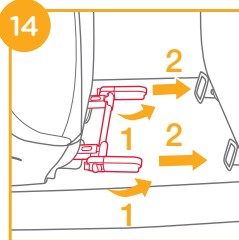
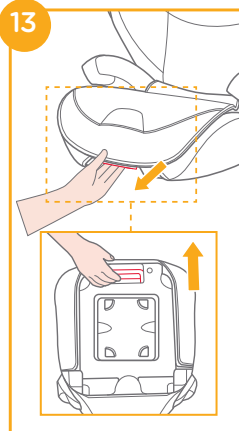
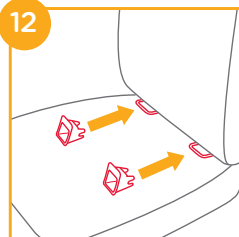

4. Line up the ISOFIX connectors with the ISOFIX anchor points, and then click both ISOFIX connectors into the ISOFIX guides. **15**

! Make sure that both ISOFIX connectors are securely attached to their ISOFIX guides. The colors of the indicators on the both ISOFIX connectors should be completely green. **15 -1**

! Check to make sure the booster is securely installed by pulling on the both ISOFIX connectors.

5. To remove the booster:

a. Press the secondary lock button **16 -1** first and then the button **16 -2** on the ISOFIX connectors before removing the booster from the vehicle seat.

b. Rotate the ISOFIX connectors by 180 degrees, then press the ISOFIX adjusting button to fold the ISOFIX connectors. **17**

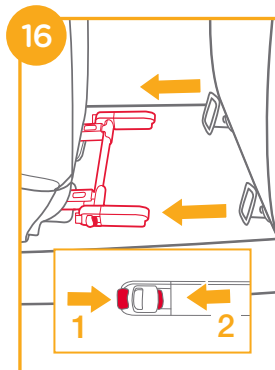
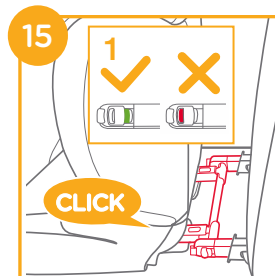

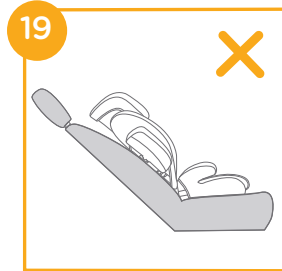
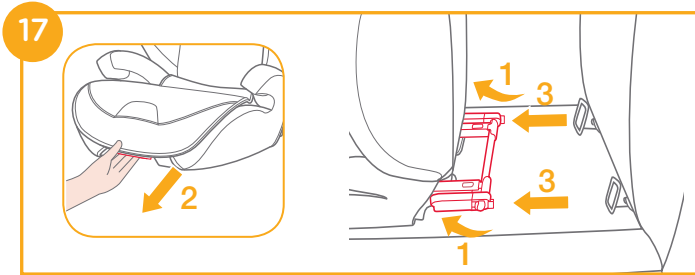

! Pull the vehicle safety belt and pass through the belt path **20**, and then buckle it up. **20**-3

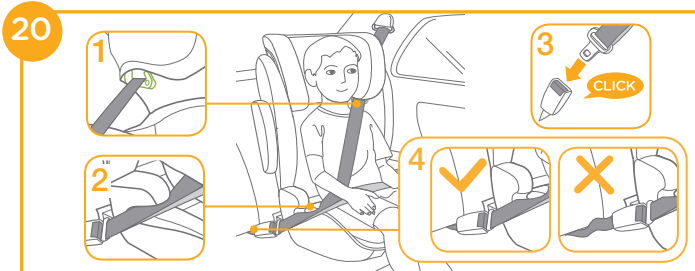

! Could also be installed by using 3-point belt only. (see images **20** - **24**)

! Position shoulder belt through the shoulder belt guide shown in **20**-1

! DO NOT position vehicle belt over top of the armrests. It must pass underneath the armrests. **20**-2

! The booster can not be used if the vehicle safety belt buckle (female buckle end) is too long to anchor the booster securely. **20**-4

! After your child is placed in this booster, the safety belt must be used correctly, and ensure that any lap strap is worn low down, so that the pelvis is firmly engaged. **20**

! To ensure the correct head support height is obtained, the bottom of the headrest MUST be even with the top of child's shoulders as shown in **21** and the shoulder belt must be positioned in the green zone as shown in **22**

! Place a booster firmly against the back of a forward-facing vehicle seat equipped with a lap/shoulder belt.



! Make sure, that the shoulder belt portion of the vehicle belt goes straight through the shoulder belt guide as shown in 23

! Tighten the vehicle belt by pulling the shoulder strap until all belt slack is removed.

! If the belt lays across child neck, head or face, readjust head support height.

! Any straps holding the booster to the vehicle should be tight and the straps should not be twisted.



To refit the seat pad simply reverse the steps above.

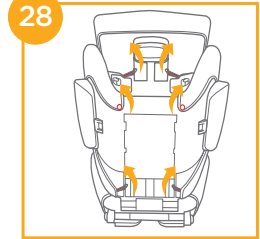
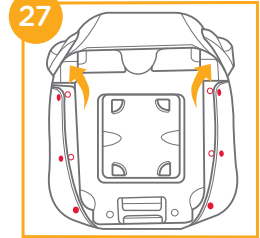

## Detach Soft Goods

see images 25 - 28

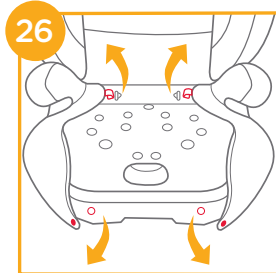
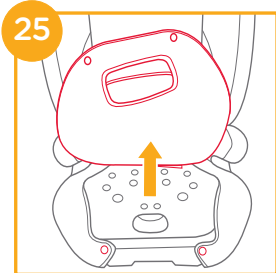

## Care and Maintenance

- ! Please wash the soft goods and inner padding with cold water under 30°C.
- ! Do not iron the soft goods.
- ! Do not bleach or dry clean the soft goods.
- ! Do not use undiluted neutral detergent, gasoline or other organic solvent to wash the booster. It may cause damage to the booster.
- ! Do not twist the soft goods and inner padding to dry with great force. It may leave the soft goods and inner padding with wrinkles.
- ! Please hang dry the soft goods and inner padding in the shade.
- ! Please remove the booster from the vehicle seat if not in use for a long period of time. Put the booster in a cool, dry place and somewhere your child cannot access it.



## Vehicle Fitting Information



1. The Joie booster is suitable for fixing into the seat positions of most cars. The figures on the diagram below correspond with the vehicle fitting positions listed in the following pages.  
Seat positions in other cars may also be suitable to accept the booster. The following Vehicle Fitting Information is only for vehicles sold in European markets. If in doubt, consult either the booster manufacturer or the distributor.
2. ALWAYS give priority to the rear seats of your vehicle.
3. If your child restraint can be fitted, it is marked with •
4. If your child restraint cannot be fitted, it is marked with x
5. Electric or hybrid vehicles are marked with ⚡
6. i-Size vehicles are marked with
7. Vehicles with underfloor storage boxes are marked with SB!
8. If the vehicle is equipped with underfloor storage boxes, these positions are marked with !  
Customers should refer to the vehicle manufacturer's handbook for use of the support leg in storage boxes.
9. If your vehicle is not listed in this manual or it is not marked with either a • or x then please refer to your vehicle's handbook or contact the manufacturer for further information.

## Installation with ISOSAFE System

① ② ③ ④ ⑤ ⑥ ⑦

### Alfa Romeo

① ② ③ ④ ⑤ ⑥ ⑦

Giulietta (2010 >)	x	.	x	.	-	-	-
Mito (2009 >)	x	.	x	.	-	-	-

### Audi

A1 (2011 >)	x	.	x	.	-	-	-
A1 Sportback (2012 >)	x	.	x	.	-	-	-
A3 Hatchback (2012 >)	x	.	x	.	-	-	-
A3 (1996 - 2003)	x	.	x	.	-	-	-
A3 S3 (2012 >)	x	.	x	.	-	-	-
⚡ A3 e-Tron Sportback (2015 >)	x	.	x	.	-	-	-
A3 Saloon (2014 >)	x	.	x	.	-	-	-
A4 Allroad (2009 >)	x	.	x	.	-	-	-
A4 Avant (2008 >)	x	.	x	.	-	-	-
A4 Saloon (2008 >)	x	.	x	.	-	-	-
A4 S4 (2009 >)	x	.	x	.	-	-	-
A4 S4 Avant (2009 >)	x	.	x	.	-	-	-
A5 (2007 >)	x	.	x	.	-	-	-
A5 Sportback (2009 >)	x	.	x	.	-	-	-
A5 S5 Sportback (2007 >)	x	.	x	.	-	-	-
A6 (2011 >)	x	.	x	.	-	-	-
A6 Allroad (2011 >)	x	.	x	.	-	-	-
A6 Avant (2011 >)	x	.	x	.	-	-	-
A6 S6 (2011 >)	x	.	x	.	-	-	-
A7 Sportback (2011 >)	x	.	x	.	-	-	-
A8 (2011 >)	x	.	x	.	-	-	-
A8 S8 (2011 >)	x	.	x	.	-	-	-
Q3 (2013 >)	x	.	x	.	-	-	-
Q5 (2009 >)	x	.	x	.	-	-	-
Q7 (2006 >)	x	.	x	.	.	.	.
TT Coupe (2006 >)	x	.	x	.	-	-	-

### Bentley

Continental GT (2003 - 2011)	x	.	x	.	-	-	-
Continental Flying Spur (2005 - 2012)	x	.	x	.	-	-	-
Continental GTC (2005 - 2012)	x	.	x	.	-	-	-
Mulsanne (2010 >)	x	.	x	.	-	-	-

### BMW

1 Series Convertible (2008 >)	x	.	x	.	-	-	-
1 Series Coupe (2008 >)	x	.	x	.	-	-	-
1 Series F20 (2011 >)	x	.	x	.	-	-	-
2 Series Active Tourer	x	.	x	.	-	-	-
2 Series Coupe	x	.	x	.	-	-	-
3 Series Coupe (2007 >)	x	.	x	.	-	-	-
3 Series F30 (2012 >)	x	.	x	.	-	-	-
5 Series Saloon (2003 - 2010)	x	.	x	.	-	-	-
5 Series Touring (2003 - 2010)	x	.	x	.	-	-	-
5 Series Touring (2011 >)	x	.	x	.	-	-	-
5 Series Saloon (2011 >)	x	.	x	.	-	-	-
5 Series (2011 >)	x	.	x	.	-	-	-
6 Series Coupe (2011 >)	x	.	x	.	-	-	-
6 Series Convertible (2011 >)	x	.	x	.	-	-	-
6 Series Gran Coupe (2011 >)	x	.	x	.	-	-	-
7 Series (2010 >)	x	.	x	.	-	-	-
i3 (2014 >)	x	.	x	.	-	-	-
X1 (2010 >)	x	.	x	.	-	-	-
X3 F25 (2011 >)	x	.	x	.	-	-	-
X4 (2014 >)	x	.	x	.	-	-	-
X5 (2007 >)	x	.	.	.	.	.	.
X5 (2015)	x	.	.	.	.	.	.
X6 (2008 >)	x	.	x	.	-	-	-
X6 (2015)	x	.	x	.	-	-	-
3-GT (2013 >)	x	.	x	.	-	-	-
5-GT (2010 >)	x	.	x	.	-	-	-

### Cadillac

BLS Saloon (2006 - 2011)	x	.	x	.	-	-	-
--------------------------	---	---	---	---	---	---	---

### Chevrolet

Aveo (2012 >)	x	.	x	.	-	-	-
Captiva (2007 >)	x	.	x	.	-	-	-
Cruze (2009 >)	x	.	x	.	-	-	-
Spark (2012 >)	x	.	x	.	-	-	-
Volt (2011 >)	x	.	x	.	-	-	-
Orlando (2011 >)	x	.	x	.	-	-	-
Traxx (2013 >)	x	.	x	.	-	-	-

### Chrysler

Grand Voyager (2008 >)	x	.	x	.	.	-	-
300 C (2012 >)	x	.	x	.	-	-	-
Delta (2011 >)	x	.	x	.	-	-	-
Ypsilon (2011 >)	x	.	x	.	-	-	-

### Citroen

SB! Berlingo Multispace (2007 >)	x	!	x	!	.	-	-
C1 (2006 >)	x	.	x	.	-	-	-
C1 (2015)	x	.	x	.	-	-	-
C3 5 Door (2009 >)	x	.	x	.	-	-	-
SB! C3 Picasso (2009 >)	x	!	x	!	-	-	-
C4 (2010 >)	x	.	x	.	-	-	-
SB! C4 Picasso (2007 >)	x	!	.	!	.	-	-
SB! C4 Picasso (2014 >)	x	!	.	!	.	-	-
C5 Saloon (2008 >)	x	.	x	.	-	-	-
C5 Tourer (2008 >)	x	.	x	.	-	-	-
 C-Cactus (2015 >)	x	.	x	.	-	-	-
DS3 (2011 >)	x	.	x	.	-	-	-
DS4 (2011 >)	x	.	x	.	-	-	-
DS5 (2013 >)	x	.	x	.	-	-	-





### Dacia

Duster (2012 >)	x	.	x	.	-	-	-
Sandero (2013 >)	x	.	x	.	-	-	-

### Fiat

500 (2008 >)	x	.	x	.	-	-	-
500 C (2009 >)	x	.	x	.	-	-	-
Abarth 500 (2009 >)	x	.	x	.	-	-	-
Bravo (2007 >)	x	.	x	.	-	-	-
500L (2013 >)	x	.	x	.	-	-	-
Panda (2012 >)	x	.	x	.	-	-	-
Grande Punto (2006 >)	x	.	x	.	-	-	-
Abarth Grande Punto (2008 - 2011)	x	.	x	.	-	-	-

### Ford

 B Max (2012 >)	x	.	x	.	-	-	-
 C Max (2003 - 2012)	x	.	.	.	-	-	-
Fiesta (2004 - 2008)	x	.	x	.	-	-	-
Fiesta (2008 >)	x	.	x	.	-	-	-
Focus (2010 >)	x	.	x	.	-	-	-
 Focus (2015 >)	x	.	x	.	-	-	-
Focus CMax (2003 - 2010)	x	.	.	.	-	-	-
SB! Galaxy (2006 >)	x	!	.	!	.	-	-
KA (2009 >)	x	.	x	.	-	-	-
Kuga (2013 >)	x	.	x	.	-	-	-
Mondeo Estate (2007 >)	x	.	x	.	-	-	-
Mondeo Hatchback (2007 >)	x	.	x	.	-	-	-
Mondeo Saloon (2007 >)	x	.	x	.	-	-	-
 Mondeo (2014 >)	x	.	x	.	-	-	-
 SB! S Max (2006 >)	x	!	.	!	.	-	-
CMax (2013 >)	x	.	.	.	-	-	-

### Honda

Accord Saloon (2008 >)	x	.	x	.	-	-	-
Accord Tourer (2008 >)	x	.	x	.	-	-	-
Civic (2012 >)	x	.	x	.	-	-	-
Civic (2006 - 2011)	x	.	x	.	-	-	-
Civic Hybrid Saloon (2006 - 2010)	x	.	x	.	-	-	-
Civic Type R (2007 - 2010)	x	.	x	.	-	-	-
Civic Tourer (2014 >)	x	.	x	.	-	-	-
CRV (2007 - 2013)	x	.	x	.	-	-	-

Hyundai

CRV (2012 >)	x	.	.	.	-	-	-
Elyson (2012 >)	x	.	x	.	.	.	-
FRV (2006 - 2011)	x	.	x	.	.	-	-
Insight (2009 >)	x	.	x	.	.	-	-
Jazz (2008 >)	x	.	x	.	.	-	-
Odyssey (2010 >)	x	.	x	.	.	-	-

i10 Hatchback (2008 >)	x	.	x	.	.	-	-
i20 Hatchback (2009 >)	x	.	x	.	.	-	-
i30 (2012 >)	x	.	x	.	.	-	-
i40 (2011 >)	x	.	x	.	.	-	-
iX20 (2011 >)	x	.	x	.	.	-	-
iX35 (2010 >)	x	.	x	.	.	-	-
SantaFe (2012 >)	x	.	x	.	.	.	.
Tucson (2010 >)	x	.	x	.	.	-	-
Veloster (2012 >)	x	.	x	.	.	-	-

Infiniti

EX (2009 >)	x	.	x	.	.	-	-
FX (2009 >)	x	.	x	.	.	-	-
G Coupe (2009 >)	x	.	x	.	.	-	-
G Saloon (2009 >)	x	.	x	.	.	-	-
M (2010 >)	x	.	x	.	.	-	-

Jaguar

X-Type (2001 - 2010)	x	.	x	.	.	-	-
X-Type Estate (2004 - 2010)	x	.	x	.	.	-	-
XF (2008 >)	x	.	x	.	.	-	-
XF R (2009 >)	x	.	x	.	.	-	-
XF Sportbrake (2013 >)	x	.	x	.	.	-	-
XJ (2010 >)	x	.	x	.	.	-	-

Jeep

XK (2006 >)	x	.	x	.	.	-	-
XK Convertible (2006 >)	x	.	x	.	.	-	-
XK R (2006 >)	x	.	x	.	.	-	-

Grand Cherokee (2011 >)	x	.	x	.	.	-	-
Compass (2011 >)	x	.	x	.	.	-	-
Cherokee (2014 >)	x	.	x	.	.	-	-

Kia

SB! Carens (2013 >)	x	!	.	!	.	-	.
Ceed Hatchback (2012 >)	x	.	x	.	.	-	-
Optima (2011 >)	x	.	x	.	.	-	-
Picanto (2008 >)	x	.	x	.	.	-	-
Rio (2012 >)	x	.	x	.	.	-	-
Sorento (2012 >)	x	.	x	.	.	-	-
Sorento (2015)	x	.	x	.	.	.	.
Soul (2009 >)	x	.	x	.	.	-	-
⚡ Soul (2015 >)	x	.	x	.	.	-	-
Sportage (2011 >)	x	.	x	.	.	-	-
Venga (2010 >)	x	.	x	.	.	-	-

Land Rover

Discovery Sport (2015 >)	x	.	x	.	.	-	.
Discovery 4 (2009 >)	x	.	x	.	.	-	.
Freelander 2 (2006 >)	x	.	x	.	.	-	-
Range Rover (2013 >)	x	.	x	.	.	-	-
Range Rover (2002 - 2012)	x	.	x	.	.	-	-
Range Rover Sport (2005 - 2012)	x	.	x	.	.	-	-
Range Rover Sport (2013 >)	x	.	x	.	.	-	.
Range Rover Evoque (2011 >)	x	.	x	.	.	-	-

Lancia

Thema (2012 >)	x	.	x	.	.	-	-
----------------	---	---	---	---	---	---	---

**Lexus**

Voyager (2010 >) x . x . . - .  
 Ypsilon (2012 >) x . x . - - -

CT (2011 >) x . x . - - -  
 ⚡ GS (2013 >) x . x . - - -  
 IS Saloon (2005 - 2012) x . x . - - -  
 RX (2010 >) x . x . - - -

**Mazda**

 CX-5 (2011 >) x . x . - - -  
 CX-7 (2007 - 2011) x . x . - - -  
 2 (2007 >) x . x . - - -  
 3 Hatchback (2009 >) x . x . - - -  
 3 Saloon (2009 >) x . x . - - -  
 3 Hatchback (2014 >) x . x . - - -  
 5 (2005 - 2010) x . x . - - -  
 6 Estate (2008 - 2012) x . x . - - -  
 6 Hatchback (2007 - 2012) x . x . - - -  
 6 Saloon (2007 - 2009) x . x . - - -  
 6 Saloon (2013 >) x . x . - - -  
 6 Estate (2012 >) x . x . - - -

**Mercedes-Benz**

A Class (2005 - 2012) x . x . - - -  
 A Class (2013 >) x . x . - - -  
 B Class (2012 >) x . . . - - -  
 ⚡ B Class (2015 >) x . . . - - -  
 C Class (2008 >) x . x . - - -  
 C Class Estate (2008 >) x . x . - - -  
 C Class Coupe (2011 >) x . x . - - -  
 CLA (2013 >) x . x . - - -  
 CLS Shootingbrake (2012 >) x . x . - - -  
 CLS Coupe (2011 >) x . x . - - -

E Class Saloon (2009 - 2012) x . x . - - -  
 E Class Coupe (2009 >) x . x . - - -  
 E Class Estate (2013) x . x . - - -  
 E Class Saloon (2013 >) x . x . - - -  
 GL Class (2006 - 2012) x . . . - - -  
 M/ML Class (2005 - 2012) x . . . - - -  
 R Class (2006 - 2012) x . . . - - -  
 S Class (2006 - 2013) x . x . - - -  
 SL Class (2012 >) x - - - - - -  
 SLK (2011 >) x - - - - - -  
 V Class (2003 - 2014) x . . . . .  
 V Class (2015 >) x . . . . .

**Mini**

Mini (Cooper) Hatchback (2006 - 2013) x . x . - - -  
 Mini (Cooper) Hatchback (2014 >) x . x . - - -  
 Mini Coupe (2009 >) x - - - - - -  
 Mini Countryman (2010 >) x . x . - - -  
 Mini Paceman (2013 >) x . x . - - -  
 Mini 5dr (2015 >) x . x . - - -

**Mitsubishi**

ASX (2010 >) x . x . - - -  
 Colt (2007 - 2013) x . x . - - -  
 Lancer (2008 - 2011) x . x . - - -  
 Lancer Sportback (2008 - 2011) x . x . - - -  
 Lancer Ralliart (2009 - 2011) x . x . - - -  
 Outlander (2007 - 2013) x . x . - - -  
 Outlander (2013 >) x . x . - - -  
 ⚡ Outlander (2015 >) x . x . - - -  
 Shogun (2007 >) x . x . - - -

**Nissan**

Evalia (2012 -2014) x . . . . - .  
 Juke (2010 >) x . x . - - -  
 Micra (2011 >) x . x . - - -



Opel

Note (2006 - 2013)	x	.	x	.	-	-	-
Note (2014 >)	x	.	x	.	-	-	-
Qashqai+2 (2008 >)	x	.	x	.	.	.	.
Qashqai (2014 >)	x	.	x	.	-	-	-
Quest MPV (2012 >)	x	.	x	.	.	.	.
X-Trail (2007 >)	x	.	x	.	-	-	-
Adam (2013 >)	x	.	x	.	-	-	-
Agila (2008 >)	x	.	x	.	-	-	-
Ampera (2011 >)	x	.	x	.	-	-	-
Antara (2007 >)	x	.	x	.	-	-	-
Astra 5dr (2010 >)	x	.	x	.	-	-	-
Astra Estate (2010 >)	x	.	x	.	-	-	-
Astra GTC (2011 >)	x	.	x	.	-	-	-
Corsa 3dr Hatchback (2006 >)	x	.	x	.	-	-	-
Corsa 5dr Hatchback (2006 >)	x	.	x	.	-	-	-
Corsa 5dr (2015 >)	x	.	x	.	-	-	-
Corsa VXR (2007 >)	x	.	x	.	-	-	-
Insignia Hatchback (2009 >)	x	.	x	.	-	-	-
Insignia Saloon (2009 >)	x	.	x	.	-	-	-
Insignia Sports Tourer (2009 >)	x	.	x	.	-	-	-
Meriva (2010 >)	x	.	x	.	-	-	-
Mokka (2013 >)	x	.	x	.	-	-	-
Vivaro (2014 >)	x	.	.	.	x	x	x
Zafira (2005 >)	x	.	.	.	.	.	.
Zafira VXR (2005 >)	x	.	.	.	.	.	.
Zafira Tourer (2014 >)	x	.	.	.	.	.	.

Peugeot

107 (2005 >)	x	.	x	.	-	-	-
108 (2015 >)	x	.	x	.	-	-	-
207 3dr (2006 - 2012)	x	.	x	.	-	-	-
207 5dr (2006 - 2012)	x	.	x	.	-	-	-
207 SW (2007 - 2012)	x	.	x	.	-	-	-
2008 (2013 >)	x	.	x	.	-	-	-

208 3dr (2013 >)	x	.	x	.	-	-	-
208 5dr (2013 >)	x	.	x	.	-	-	-
307 (2001 - 2007)	x	.	x	.	-	-	-
307 Estate (2002 - 2007)	x	.	x	.	-	-	-
308 Hatchback (2007 >)	x	.	.	.	-	-	-
308 SW (2008 >)	x	.	x	.	-	-	-
308 (2014 >)	x	.	x	.	-	-	-
SB! 3008 (2009 >)	x	!	x	!	-	-	-
508 (2011 >)	x	.	x	.	-	-	-
508 SW (2011 >)	x	.	x	.	-	-	-
⚡ 508 RXH (2013 >)	x	.	x	.	-	-	-
SB! 5008 (2011 >)	x	!	x	!	.	.	.
RCZ (2011 >)	x	.	x	.	-	-	-

Porsche

⚡ Cayenne (2011 >)	x	.	x	.	-	-	-
⚡ Panamera (2011 >)	x	.	x	.	-	-	-
Cayenne (2015 >)	x	.	x	.	-	-	-
Panamera (2015 >)	x	.	x	.	-	-	-

Renault

Captur (2015 >)	x	.	x	.	-	-	-
Clio (2005 - 2012)	x	.	x	.	-	-	-
Clio Renault Sport (2006 - 2012)	x	.	x	.	-	-	-
Clio Sport Tourer (2007 - 2012)	x	.	x	.	-	-	-
Clio (2013 >)	x	.	x	.	-	-	-
Laguna (2008 - 2012)	x	.	x	.	-	-	-
Laguna Sport Tourer (2008 - 2012)	x	.	x	.	-	-	-
SB! Megane Hatchback (2008 >)	x	!	x	!	-	-	-
Megane Sport Tourer (2009 >)	x	.	x	.	-	-	-
Modus (2004 - 2012)	x	.	x	.	-	-	-
Grand Modus (2008 - 2012)	x	.	x	.	-	-	-
SB! Scenic (2009 >)	x	!	x	!	.	.	.
Trafic (2001 - 2014)	x	.	.	.	.	.	.
Twingo (2007 >)	x	.	x	.	-	-	-
Twingo (2012 >)	x	.	x	.	-	-	-
Twingo (2015 >)	x	.	x	.	-	-	-

**Saab**

9-3 (2002 - 2012)	x	.	x	.	-	-	-
9-3 Sport Wagon (2005 - 2012)	x	.	x	.	-	-	-
9-3 X (2009 - 2012)	x	.	x	.	-	-	-
9-5 Estate (2005 - 2010)	x	.	x	.	-	-	-
9-5 (2011 - 2012)	x	.	x	.	-	-	-

**Seat**

SB! Alhambra (2010 >)	x	!	.	!	.	-	.
Altea (2004 - 2011)	x	.	x	.	-	-	-
Altea XL (2007 - 2011)	x	.	x	.	-	-	-
Altea Freerack4 (2007 - 2009)	x	.	x	.	-	-	-
Exeo (2008 >)	x	.	x	.	-	-	-
Exeo ST Estate (2008 >)	x	.	x	.	-	-	-
Ibiza Cupra (2009 >)	x	.	x	.	-	-	-
Ibiza FR (2009 >)	x	.	x	.	-	-	-
Ibiza Hatchback (2008 - 2013)	x	.	x	.	-	-	-
Leon Cupra (2007 - 2011)	x	.	x	.	-	-	-
Leon FR (2006 - 2012)	x	.	x	.	-	-	-
Leon Hatchback (2005 - 2012)	x	.	x	.	-	-	-
Leon (2013 >)	x	.	x	.	-	-	-
Mii (2011 >)	x	.	x	.	-	-	-
Toledo (2013 >)	x	.	x	.	-	-	-

**Skoda**

Citigo (2012 >)	x	.	x	.	-	-	-
Fabia Estate Combi (2008 >)	x	.	x	.	-	-	-
Fabia Hatchback (2007 >)	x	.	x	.	-	-	-
Octavia Estate Combi (2005 - 2013)	x	.	x	.	-	-	-
Octavia Hatchback (2004 - 2012)	x	.	x	.	-	-	-
Octavia Scout (2007 - 2013)	x	.	x	.	-	-	-
Octavia Hatchback (2013 >)	x	.	x	.	-	-	-
Rapid (2013 >)	x	.	x	.	-	-	-
Roomster (2006 >)	x	.	x	.	-	-	-
Superb Combi Estate (2008 >)	x	.	x	.	-	-	-
 Superb (2008 >)	x	.	x	.	-	-	-
Yeti (2009 >)	x	.	x	.	-	-	-

**Smart**

For Two Coupe (2007 >)	x	-	-	-	-	-	-
------------------------	---	---	---	---	---	---	---

**Suzuki**

Alto (2009 >)	x	.	x	.	-	-	-
Grand Vitara (2006 >)	x	.	x	.	-	-	-
Splash (2008 >)	x	.	x	.	-	-	-
Swift Sport (2011 >)	x	.	x	.	-	-	-
SX-4 (2006 >)	x	.	x	.	-	-	-
SX-4 Saloon (2009 >)	x	.	x	.	-	-	-

**Subaru**

BRZ (2012 >)	x	.	x	.	-	-	-
Forester (2013 >)	x	.	x	.	-	-	-
Impreza 5 Door (2013 >)	x	.	x	.	-	-	-
Legacy (2012 >)	x	.	x	.	-	-	-
Outback (2012 >)	x	.	x	.	-	-	-
XV Hatchback (2011 >)	x	.	x	.	-	-	-

**Toyota**



Auris (2007 - 2012)	x	.	x	.	-	-	-
Auris (2013 >)	x	.	x	.	-	-	-
Avensis Hatchback (2003 - 2011)	x	.	x	.	-	-	-
Avensis Tourer (2009 >)	x	.	x	.	-	-	-
Aygo (2005 >)	x	.	x	.	-	-	-
Aygo (2014 >)	x	.	x	.	-	-	-
EZ MPV (2013 >)	x	.	x	.	-	-	-
GT86 (2012 >)	x	.	x	.	-	-	-
Highlander (2013 >)	x	.	x	.	-	-	-
Land Cruiser (2003 - 2009)	x	.	x	.	-	-	-

⚡ Land Cruiser (2009 >)	x	.	x	.	-	-	-
Prius (2004 - 2009)	x	.	x	.	-	-	-
Prius (2010 >)	x	.	x	.	-	-	-
Prius (2015 >)	x	.	x	.	-	-	-
Prius Plus + (2012 >)	x	.	x	.	-	-	-
Rav 4 MK3 (2006 - 2011)	x	.	x	.	-	-	-
RAV4 (2013 >)	x	.	x	.	-	-	-
SB! Verso (2009 - 2012)	x	!	x	!	-	-	-
SB! Verso (2013 >)	x	!	x	!	-	-	-
Yaris Hatchback (2011 >)	x	.	x	.	-	-	-

Vauxhall

Adam (2013 >)	x	.	x	.	-	-	-
Agila (2008 >)	x	.	x	.	-	-	-
Ampera (2011)	x	.	x	.	-	-	-
Antara (2007 >)	x	.	x	.	-	-	-
Astra 5dr (2010 >)	x	.	x	.	-	-	-
Astra Estate (2010 >)	x	.	x	.	-	-	-
Astra GTC (2011 >)	x	.	x	.	-	-	-
Corsa D (2007 >)	x	.	x	.	-	-	-
Corsa 3dr Hatchback (2006 >)	x	.	x	.	-	-	-
Corsa 5dr Hatchback (2006 >)	x	.	x	.	-	-	-
Corsa 5dr (2015 >)	x	.	x	.	-	-	-
Corsa VXR (2007 >)	x	.	x	.	-	-	-
Insignia Hatchback (2009 >)	x	.	x	.	-	-	-
Insignia Saloon (2009 >)	x	.	x	.	-	-	-
Insignia Sports Tourer (2009 >)	x	.	x	.	-	-	-
Meriva (2010 >)	x	.	x	.	-	-	-
Mokka (2013 >)	x	.	x	.	-	-	-
Vivaro (2014 >)	x	.	.	.	x	x	x
Zafira (2005 >)	x	.	.	.	.	.	.
Zafira VXR (2005 - 2010)	x	.	.	.	.	.	.
Zafira Tourer (2012 >)	x	.	.	.	.	.	.

Volkswagen

Beetle (2012 >)	x	.	x	.	-	-	-
Multivan Caravelle (2008)	x	.	x	.	-	-	-
Golf Cabriolet (2009 - 2012)	x	.	x	.	-	-	-
Golf Hatchback (2009 - 2012)	x	.	x	.	-	-	-
⚡ Golf Hatchback MK7 (2012 >)	x	.	x	.	-	-	-
Golf Plus (2009 - 2011)	x	.	x	.	-	-	-
Jetta (2011 >)	x	.	x	.	-	-	-
Passat (2010 >)	x	.	x	.	-	-	-
Passat (2005 - 2010)	x	.	x	.	-	-	-
 Passat Saloon (2015 >)	x	.	x	.	-	-	-
Passat Alltrack (2012 >)	x	.	x	.	-	-	-
Passat CC (2008 >)	x	.	x	.	-	-	-
Passat Estate (2005 - 2011)	x	.	x	.	-	-	-
 Passat Estate (2015 >)	x	.	x	.	-	-	-
Polo 3dr (2009 >)	x	.	x	.	-	-	-
Polo 5dr (2009 >)	x	.	x	.	-	-	-
Scirocco (2011)	x	.	x	.	-	-	-
SB! Sharan (2010 >)	x	!	.	!	.	.	.
Tiguan (2008 >)	x	.	x	.	-	-	-
Touareg (2012 >)	x	.	x	.	-	-	-
SB! Touran (2010 >)	x	!	.	!	.	.	.
Transporter 5 (2003 >)	x	.	.	.	.	.	.
UP! (2012 >)	x	.	x	.	-	-	-

Volvo

C30 (2007 - 2013)	x	.	x	.	-	-	-
S60 (2010 >)	x	.	x	.	-	-	-
S80 (2007 >)	x	.	x	.	-	-	-
V40 (2013 >)	x	.	x	.	-	-	-
V40 Cross Country (2012 >)	x	.	x	.	-	-	-
V60 (2011 >)	x	.	x	.	-	-	-
⚡ V60 (2015 >)	x	.	x	.	-	-	-
V70 (2008 >)	x	.	x	.	-	-	-
XC60 (2008 >)	x	.	x	.	-	-	-
XC70 (2008 >)	x	.	x	.	-	-	-
XC90 (2003 - 2013)	x	.	x	.	.	.	x





Allison Baby UK Ltd.  
Venture Point, Towers Business Park,  
Rugeley, Staffordshire, WS15 1UZ

view all fine signature selections at  
[joiebaby.com/signature](http://joiebaby.com/signature)

IM-000468D