



# **MBX7 Compact Stroller**

**GB** Instruction Manual

**ES** Manual de instrucciones



**IMPORTANT, RETAIN FOR FUTURE REFERENCE: READ CAREFULLY**

# Welcome to the familiee

Your trust in our product means the world to us, and we're thrilled to be a part of your parenting journey. Our team has worked tirelessly to ensure that this product provides comfort, safety, and style for you and your little one. We're confident it will exceed your expectations. Should you have any questions or require assistance in the future, please don't hesitate to reach out. Thank you for choosing My Babiie; we wish you and your family countless wonderful times ahead.

## Get to know your Stroller

Scan the QR code below on your camera app to be linked off to our page to get all the information you need for using your stroller. From setting it up to how to fold it down, it's all there!



# Warranty

---

We provide a 1 year warranty against manufacturing or material defects. The warranty period is effective from the day of purchase and applicable to the UK and Ireland. If you made your purchase from an authorised retailer, please return your product to them.

If you bought your product via our website; mybabiie.com, please contact our Customer Service team via email (info@mybabiie.com). We are happy to refund any product if you change your mind about your purchase (if purchased from our website, mybabiie.com.) As long as you tell us within 30 days of receiving your goods. They must be returned in an unused condition, in the original, undamaged packaging and complete with all original parts and accessories. Proof of purchase is required.

What is not covered by the Guarantee?

- Failure to follow My Babiie user guide and maintenance instructions.
- Damage caused by non domestic use
- General wear and tear, for example: worn wheels, damaged rain covers, worn/torn fabric.
- Deliberate damage, misuse or neglect.
- Product which has been modified, undergone an unauthorised repair or used a non approved spare part.
- Car seats which have been involved in an accident, we recommend all car seats should be replaced if involved in an accident.
- Cosmetic damage.
- Parts subject to normal wear and tear, foam handles, rubber elements of wheels, signs of fabric wear.
- Loss incurred as a result of not being able to use a product whilst waiting for a spare part or repair.

A repair service is available for any item that sustains accidental damage at any point during its lifespan. If the damages are not covered by our guarantee, we will provide a quote for the repair costs on an individual basis. If you find yourself in need of spare parts that are not covered by the warranty, you can purchase each spare part on our website (subject to availability).

To read more about your guarantee, please visit [mybabiie.com/guarantee](https://mybabiie.com/guarantee).

Our guarantee is provided by My Babiie Ltd, Registered address: 15 Commercial Road, Paddock Wood, Kent, TN12 6EN .

Your statutory rights are not affected by the guarantee.

Registering your Warranty

To register your warranty please visit [www.mybabiie.com/warranties](https://www.mybabiie.com/warranties)

Registering for your product warranty allows you to claim repairs or replacements if your product develops a fault. It will also help us contact you in the event of a product issue that you may need to be made aware of.

Problems or Questions

If you have any questions about your product then please drop us an email at [info@mybabiie.com](mailto:info@mybabiie.com) and we will get back to you as soon as possible. Alternatively, you can chat to us on our Live Support Chat on our website [mybabiie.com](https://mybabiie.com) or contact us via our social media channels.

# Assembly

## 1 Open the stroller

Raise the handle while simultaneously pressing both buttons, as demonstrated, to release the frame.

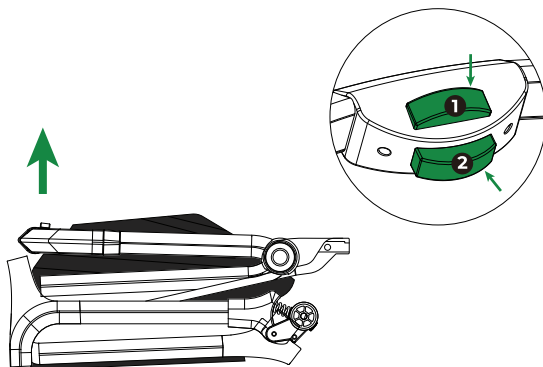

- 2 When the stroller is fully unfolded, you should hear "click" sounds on both sides of the frame. Please carefully check if the stroller is securely locked in the open position before using it.

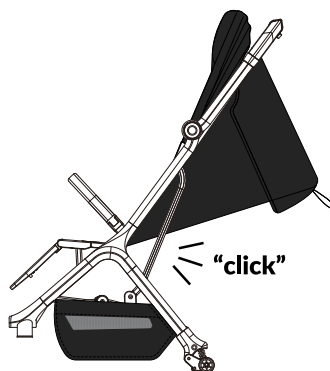

- 3 Assemble the rear wheels as follows: Take one of the rear wheels and insert the axle into the corresponding plastic hole, as shown in the picture. Ensure that you hear a distinct "click" sound, indicating that it is securely locked in place. Repeat the same process for the other side rear wheel.

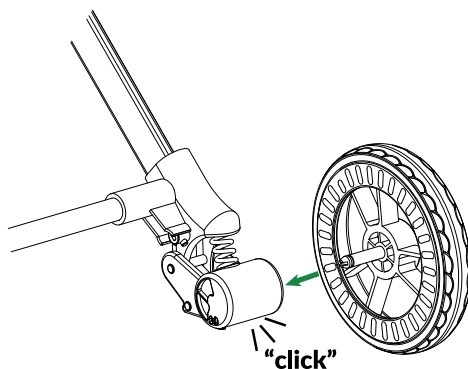

- 4** Disassemble the rear wheels by pulling the small metal pins in the direction indicated by the arrow using one hand. Simultaneously, remove the rear wheel in the direction of the arrow to complete the disassembly.

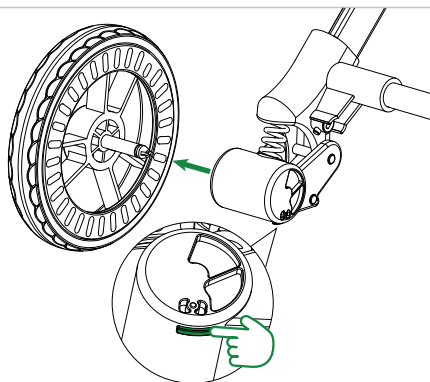

- 5** Assemble the front wheels as follows: Take one of the front wheels and insert the vertical shaft into the plastic hole on the wheel housing, as shown in the picture, until it securely locks. Install the other side of the front wheel in the same manner.

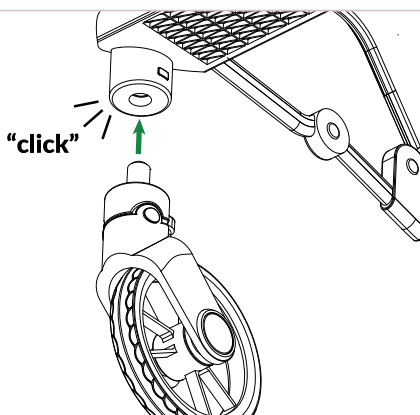

- 6** Disassemble the front wheels by pressing the small button as indicated by the arrow with one hand. Simultaneously, use your other hand to pull out the front wheel to complete the disassembly.

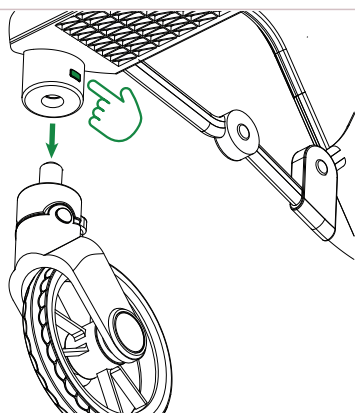

## 7 Using the brakes

Press down on the brake pedal to engage the brakes on the stroller, and lift up the pedal to release the brake.

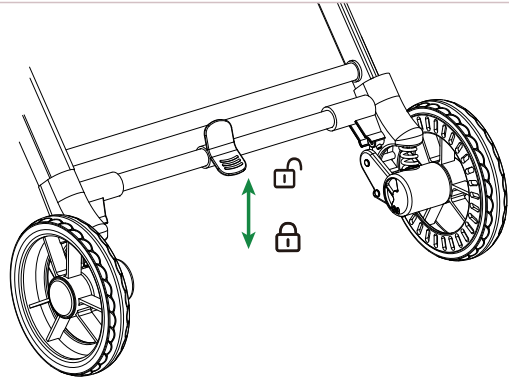

## 8 Assemble the bumper bar

Insert the bumper into the plastic holes on both sides of the seat. Please ensure that you lock the bumper in place when you hear the "click" sound.

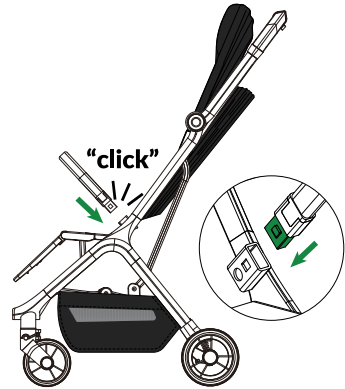

## 9 Disassemble the bumper bar

Press the buttons on both sides of the bumper bar and simultaneously pull the bumper bar out to complete the disassembly.

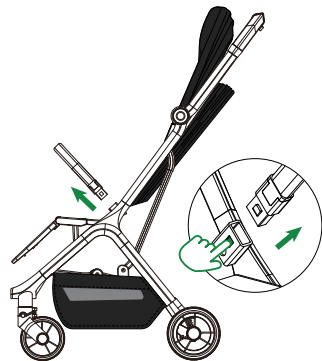

- 10** The bumper bar can be rotated 360 degrees when you pull out only one side of it.

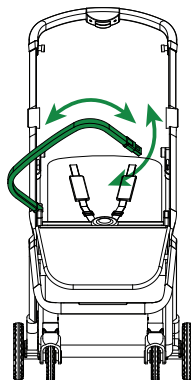

- 11** **Adjust the footrest**  
Press the plastic buttons on the back sides of the footrest to adjust it in two positions.

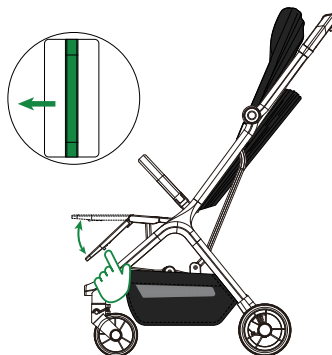

- 12** **Extend or fold the canopy**  
Open or close the zipper to extend or fold the canopy, as shown in the picture.

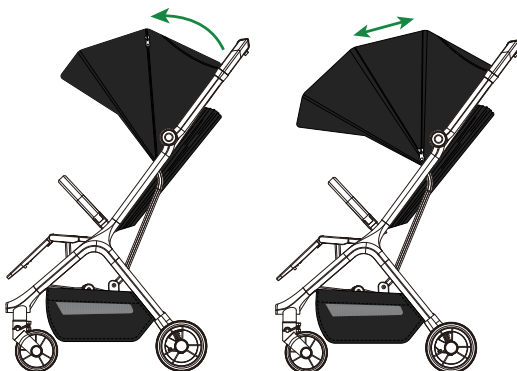

**13 Backrest adjustment**

Pull down the backrest adjustment handle to increase the backrest angle.

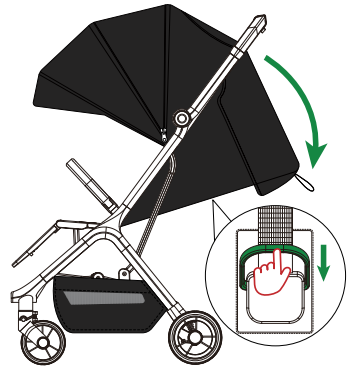

**14 Backrest adjustment**

Pulling up the adjustment belt decreases the backrest angle.

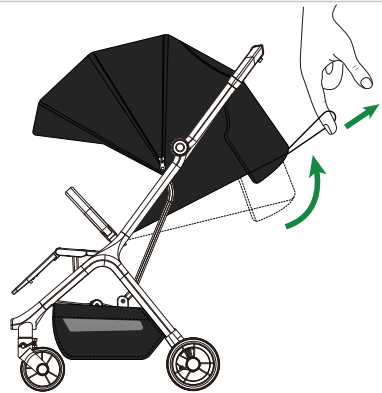

**15** When the backrest is in the sitting position, the adjustment belt may be too long and touch the ground after folding. Please secure the adjustment belt on the back of the canopy before folding the stroller.

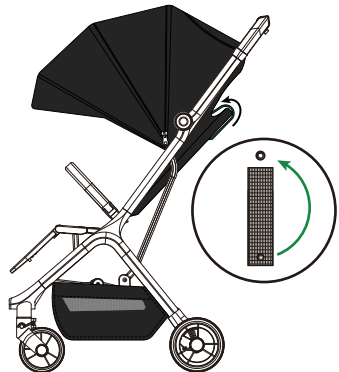



## 16 Folding the stroller

Hold down the second lock and simultaneously press the one-hand folding button to unlock the folding joint, allowing the handlebar to drop automatically and complete the automatic folding, standing process.

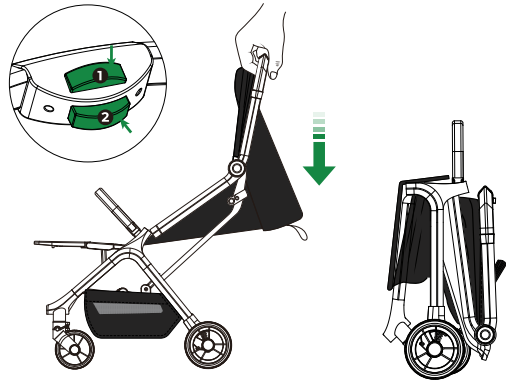

## 17 Using the safety belt

Insert component "b1" into component "a1," and insert component "b2" into component "a2." A click will indicate that they are attached correctly.

Place component "a2" on top of component "a1," and place the buckle component "c" on top of components "a1-a2," as shown in the image. A click will indicate that it is attached correctly.

Push the buttons either side of the centre piece to release the buckle.

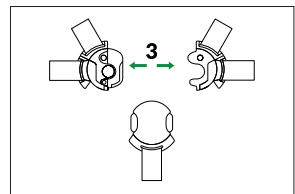
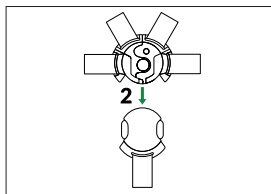
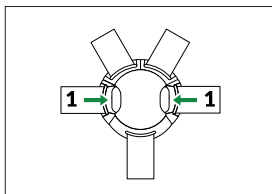
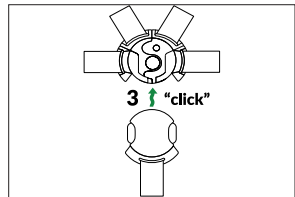
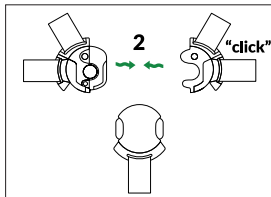
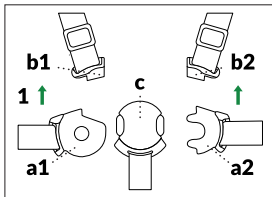

# Stroller Warnings

---

## **IMPORTANT - READ CAREFULLY AND KEEP THESE INSTRUCTIONS FOR FUTURE REFERENCE**

Remove all packaging and non-permanent labels and dispose of safely before using this product.

The safety of your child could be put at risk if you do not follow these instructions.

This stroller is designed for 1 child from 0 months up to a weight of 22 kg.

**WARNING:** Never leave the child unattended.

**WARNING:** Uneven or excessive loading of items on or in the stroller may cause the product to tip and may cause injury.

**WARNING:** Maximum intended weight within the shopping basket is 3kg.

**WARNING:** Ensure that all the locking devices are engaged before use.

**WARNING:** To avoid injury ensure that the child is kept away when unfolding and folding this stroller.

**WARNING:** Do not let the child play with this product.

**WARNING:** Always use the restraint system.

**WARNING:** Check that the stroller body is correctly engaged before use.

**WARNING:** Do not put hot drinks or liquids in the cup holder.

**WARNING:** This product is not suitable for running or skating.

**WARNING:** Do not insert any additional mattresses into the stroller.

**WARNING:** Accessories which are not approved by the manufacturer shall not be used.

**WARNING:** This pushchair has been designed for one child and shall be used for the transport for only one child!

**WARNING:** Always use the crotch strap in combination with the waist belt.

**WARNING:** This stroller does not replace a cot or a bed. Should your child need to sleep, then it should be placed in a suitable cot or bed.

**WARNING:** Only replacement parts supplied or recommended by My Babiie shall be used.

**WARNING:** Any load attached to the handle and on the back of the backrest and on the sides of the stroller will affect the stability of the stroller.

**WARNING:** The parking device shall be engaged when placing and removing the children.

EN 1888-1:2018+A1:2022 and EN 1888-2:2018+A1:2022 approved

## **Care and Maintenance**

- Please check on a regular basis that the brakes, wheels, latches, connecting elements, belt systems and seams are properly functional.
- Do not expose the stroller to strong sunshine.
- Sponge clean only.
- After use in rain or snow, the wheels should be lubricated and the stroller dried to prevent rust.
- Care for, clean and check this stroller regularly.

# Stroller do's & don'ts



## Do use your brakes!

Ensure the parking brake is engaged during the loading and unloading of children & when the pushchair is stationary.

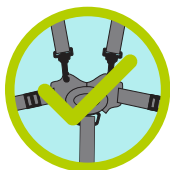

## Do always use the restraint system!

Ensure that the child restraint system is correctly fitted at all times.



## Do keep your pushchair clean and dirt free.

Use a clean white cloth, warm water and a mild detergent to keep your pushchair clean.

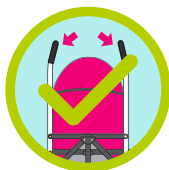

## Do always keep two hands on the handles when pushing.

You could lose control of your pushchair if not steering with both hands.



## Do follow manufacturers instructions when assembling and using your pushchair.

For safety, please refer to our instruction manuals or contact customer support if you're unsure.



## Don't use your pushchair up and down stairs!

Don't use your pushchair up or down stairs or to bump kerbs.



## Don't hang bags off the handles!

Bags and other items should not be hung from the handles as this can affect the stability of the pushchair.



## Don't run or skate with your pushchair!

Our products are not suitable for running or skating.



## Don't carry the stroller with baby inside!

Our pushchairs are not designed to be carried with your baby inside them.



## Don't put hot drinks in the cup holder.

Hot drinks burn and can easily spill from the bottle holder.



## Don't jetwash your pushchair.

Some jet washers are very powerful and could damage parts of your pushchair!



## Don't leave your child un-attended in their pushchair.

Always keep your child and pushchair in view to avoid accidents.



## Don't treat your pushchair like a trolley.

Don't load your pushchair up with all your shopping as they are not built for this purpose and could cause damage.



## Don't use your pushchair as a bumper cart!

Damage can easily occur if your pushchair is knocked into other things.



## Don't smoke around your pushchair.

We wouldn't want your pushchair or little one getting hurt or damaged!



## Don't leave your pushchair unattended on extreme gradients.

Even with your brakes on your pushchair is at risk from tipping or sliding on extreme gradients!



## Don't sit in the pushchair unless the user is under the guideline weight.

Our pushchairs are designed to hold a maximum weight. If exceeded this will cause damage!



## Do enjoy your My Babie product!

Go out and have fun adventures with your little one!

## 1 Abre el cochecito

Levanta el mango mientras presionas ambos botones simultáneamente, como se muestra, para liberar la estructura.

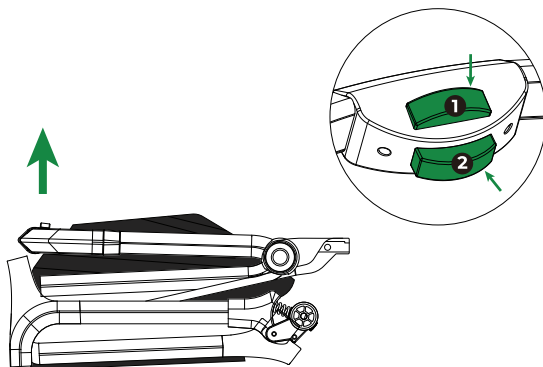

- 2 Cuando el cochecito esté completamente desplegado, deberías escuchar sonidos de "clic" en ambos lados de la estructura. Por favor, verifica cuidadosamente si el cochecito está firmemente bloqueado en la posición abierta antes de usarlo.

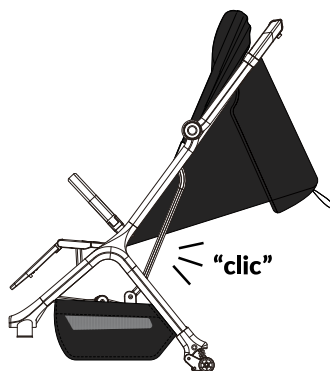

- 3 Ensambla las ruedas traseras de la siguiente manera: toma una de las ruedas traseras e inserta el eje en el agujero de plástico correspondiente, como se muestra en la imagen. Asegúrate de escuchar un sonido distintivo de "clic", lo que indica que está firmemente bloqueado en su lugar. Repite el mismo proceso para la otra rueda trasera.

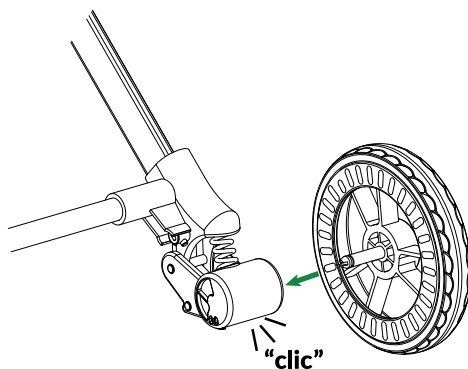

- 4** Desmonta las ruedas traseras tirando de los pequeños pasadores de metal en la dirección indicada por la flecha con una mano. Al mismo tiempo, retira la rueda trasera en la dirección de la flecha para completar el desmontaje.

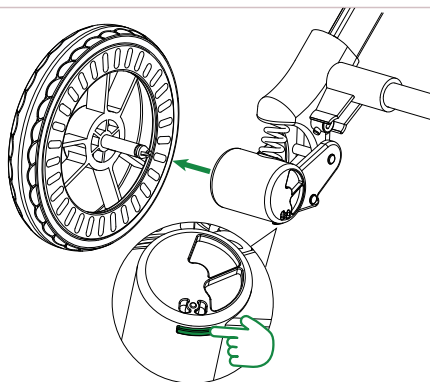

- 5** Ensambla las ruedas delanteras de la siguiente manera: toma una de las ruedas delanteras e inserta el eje vertical en el agujero de plástico en la carcasa de la rueda, como se muestra en la imagen, hasta que quede firmemente bloqueado. Instala el otro lado de la rueda delantera de la misma manera.

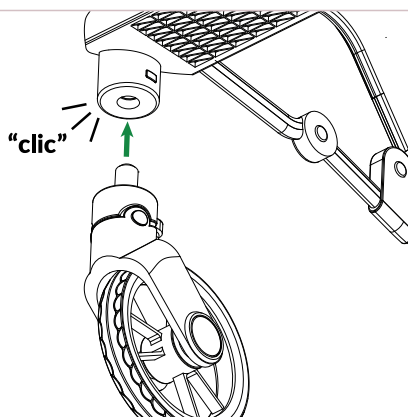

- 6** Desmonta las ruedas delanteras presionando el pequeño botón según indica la flecha con una mano. Al mismo tiempo, usa la otra mano para tirar hacia afuera de la rueda delantera y completar el desmontaje.

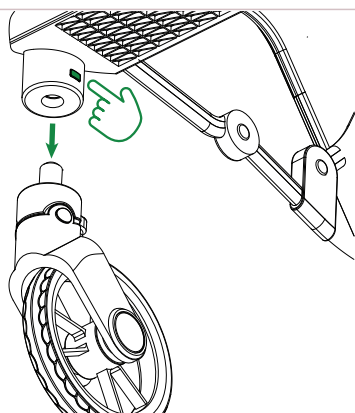

## 7 Utilización de los frenos

Presiona el pedal del freno hacia abajo para activar los frenos en el cochecito y levanta el pedal para liberar el freno.

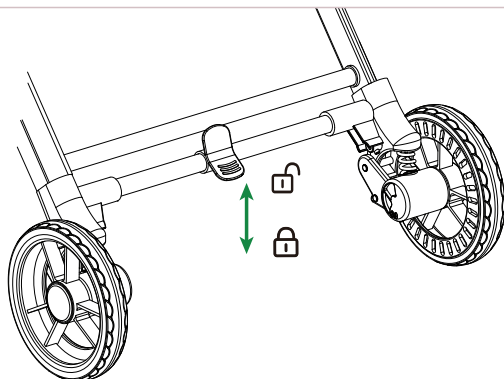

## 8 Ensambla la barra parachoques

Inserta la barra parachoques en los agujeros de plástico en ambos lados del asiento. Asegúrate de bloquear la barra parachoques en su lugar al escuchar el sonido de "clik".

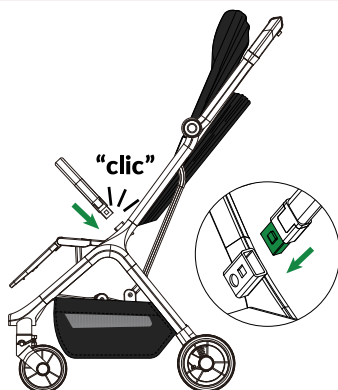

## 9 Desmonta la barra parachoques

Presiona los botones en ambos lados de la barra parachoques y, al mismo tiempo, tira hacia afuera la barra parachoques para completar el desmontaje.

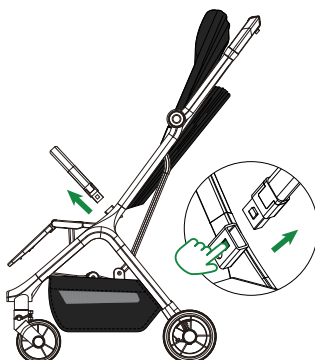

- 10** La barra parachoques se puede girar 360 grados cuando tiras hacia afuera solo un lado de la misma.

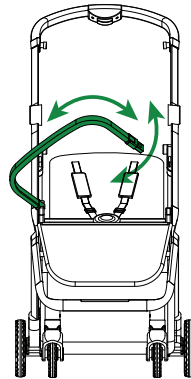

- 11** **Ajusta el reposapiés**  
Presiona los botones de plástico en los lados traseros del reposapiés para ajustarlo en dos posiciones.

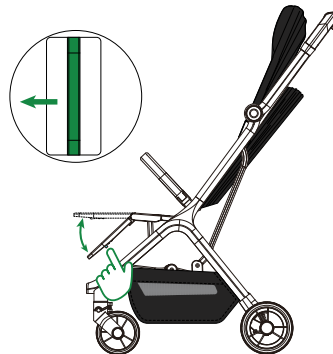

- 12** **Extiende o dobla la capota**  
Abre o cierra la cremallera para extender o plegar la capota, según se muestra en la imagen.

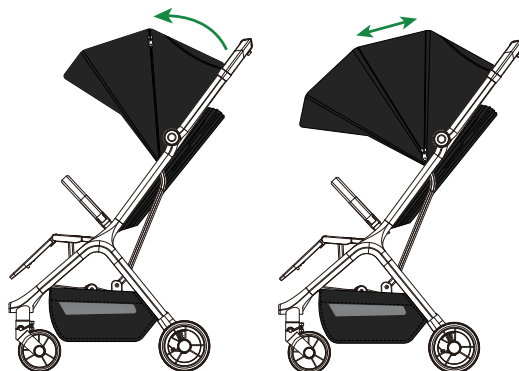

### 13 Ajuste del respaldo

Tira hacia abajo del mango de ajuste del respaldo para aumentar el ángulo del respaldo.

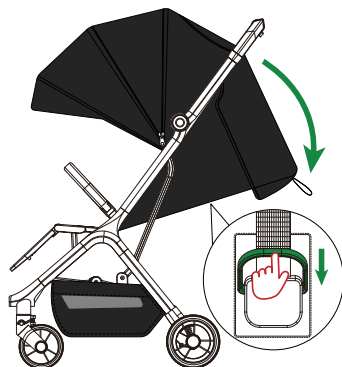

### 14 Ajuste del respaldo

Al jalar hacia arriba la correa de ajuste, disminuirás el ángulo del respaldo.

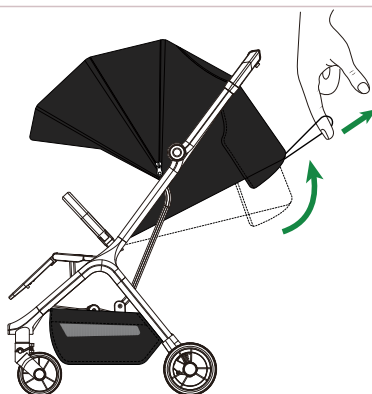

15 Cuando el respaldo esté en la posición de sentado, la correa de ajuste puede ser demasiado larga y tocar el suelo después de plegarse. Asegúrate de sujetar la correa de ajuste en la parte posterior de la capota antes de plegar el cochecito.

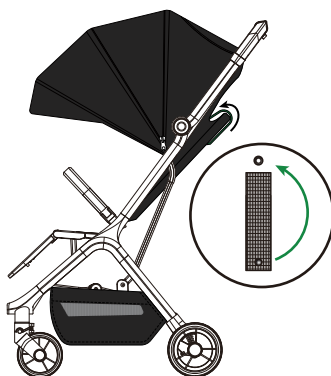



## 16 Plegar el cochecito

Mantén presionado el segundo seguro y, al mismo tiempo, presiona el botón de plegado con una mano para desbloquear la articulación de plegado, permitiendo que el manillar se caiga automáticamente y completando así el proceso de plegado automático, quedando en posición vertical.

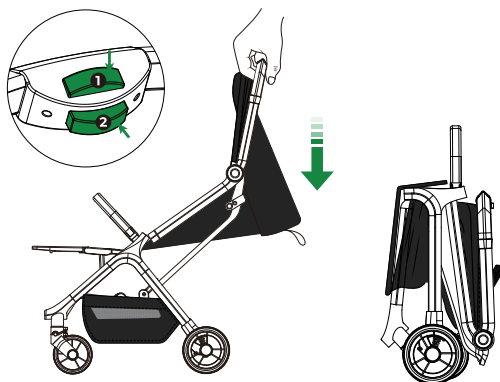

## 17 Uso del cinturón de seguridad

Inserta el componente "b1" en el componente "a1" y el componente "b2" en el componente "a2". Un clic indicará que están conectados correctamente.

Coloca el componente "a2" encima del componente "a1" y coloca el componente del cierre "c" encima de los componentes "a1-a2", según se muestra en la imagen. Un clic indicará que está conectado correctamente.

Presiona los botones a cada lado de la pieza central para liberar el cierre.

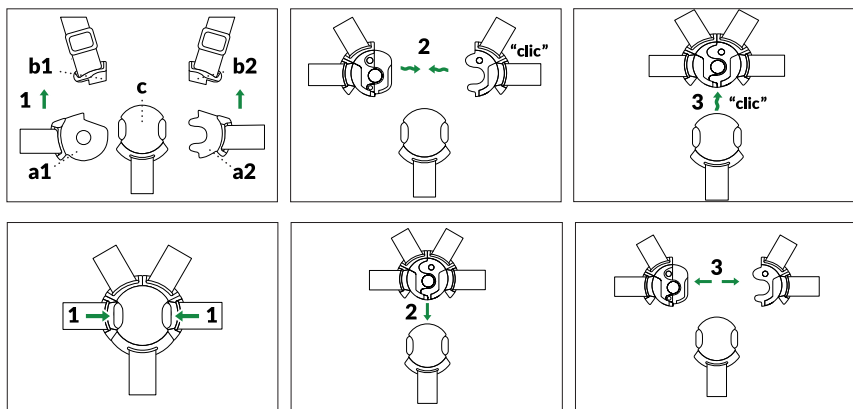

## **IMPORTANTE: LEER CON ATENCIÓN Y GUARDAR ESTAS INSTRUCCIONES PARA REFERENCIA FUTURA**

Retire todo el embalaje y las etiquetas no permanentes y deséchelos de manera segura antes de usar este producto. La seguridad de su hijo podría estar en riesgo si no sigue estas instrucciones. Este cochecito está diseñado para 1 niño desde 0 meses hasta un peso de 22 kg.

ADVERTENCIA: Nunca deje al niño sin supervisión.

ADVERTENCIA: Cargar de manera desigual o excesiva elementos en el cochecito puede hacer que el producto se incline y causar lesiones.

ADVERTENCIA: El peso máximo previsto dentro de la cesta de compras es de 3 kg.

ADVERTENCIA: Asegúrese de que todos los dispositivos de bloqueo estén activados antes de usar.

ADVERTENCIA: Para evitar lesiones, asegúrese de que el niño se mantenga alejado al desplegar y plegar este cochecito.

ADVERTENCIA: No deje que el niño juegue con este producto.

ADVERTENCIA: Utilice siempre el sistema de restricción.

ADVERTENCIA: Verifique que el cuerpo del cochecito esté correctamente asegurado antes de usar.

ADVERTENCIA: No coloque bebidas calientes o líquidos en el portavasos.

ADVERTENCIA: Este producto no es adecuado para correr o patinar.

ADVERTENCIA: No inserte ningún colchón adicional en el cochecito.

ADVERTENCIA: No se deben usar accesorios que no estén aprobados por el fabricante.

ADVERTENCIA: Este cochecito ha sido diseñado para un solo niño y solo debe usarse para transportar a un solo niño.

ADVERTENCIA: Use siempre la correa entrepierna en combinación con el cinturón de cintura.

ADVERTENCIA: Este cochecito no sustituye a una cuna o una cama. Si su hijo necesita dormir, debe colocarse en una cuna o cama adecuada.

ADVERTENCIA: Solo deben usarse piezas de repuesto suministradas o recomendadas por My Babiie.

ADVERTENCIA: Cualquier carga sujeta al mango, en la parte posterior del respaldo y en los lados del cochecito afectará la estabilidad del mismo.

ADVERTENCIA: El dispositivo de estacionamiento debe estar activado al colocar y quitar a los niños.

Aprobado según EN 1888-1:2018+A1:2022 y EN 1888-2:2018+A1:2022

### **Cuidado y Mantenimiento**

- Verifique regularmente que los frenos, ruedas, pestillos, elementos de conexión, sistemas de cinturones y costuras estén funcionando correctamente.
- No exponga el cochecito a la luz solar intensa.
- Limpie solo con esponja.
- Después de usarlo bajo la lluvia o la nieve, lubrique las ruedas y seque el cochecito para evitar la oxidación.
- Cuidado, limpie y verifique este cochecito regularmente.

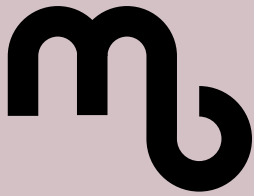

## Register your product

[www.mybabiie.com/warranties](http://www.mybabiie.com/warranties)

In the first instance of needing assistance please contact your original place of purchase.

This product qualifies for 12 month warranty when registered through our website

**mybabiie.com**



My Babiie



@MyBabiieOfficial



My Babiie



@mybabiie\_official



@MyBabiie

My Babiie Ltd, Paddock Wood, Kent, TN12 6EN

My Babiie EU , Generaal Vetterstraat 76A, 1059 BW Amsterdam, The Netherlands